

V992E-IR4-B (EMEA) NETWORK DOME CAMERA



Vicon's V992E-IR4 high definition vandal resistant network dome camera is designed for security installations that need a compact vandal resistant camera that delivers outstanding imaging at 1080P resolution. The integrated IR LEDs allows the camera to deliver crisp clear images in low light conditions.

The V992E-IR4 camera provides dual-streaming video and supports H.264 compression technology, drastically reducing file sizes and conserving valuable network bandwidth. Users can receive multiple streams simultaneously in different resolutions, frame rates and image qualities for viewing on different platforms.

Installation is made easy and cost effective with Power over Ethernet (IEEE 802.3af), which eliminates the need for power cables. This compact camera fits unobtrusively in any location. In order to adapt to the low light lighting conditions, the V992E-IR4 has integrated IR LEDs designed to illuminate the scene up to 15 meters. The camera is ONVIF compliant and can be used with many popular VMS systems.

Product at a Glance

- ▶ 1080p resolution (1920 x 1080)
- ▶ 0.63 lux @ 50 IRE (IR LEDs off)
- ▶ 4mm fixed lens
- ▶ 120 dB WDR
- ▶ Power-over-Ethernet (IEEE 802.3af) or 12VDC
- ▶ IR LEDs (15m range)
- ▶ Compact outdoor design
- ▶ Privacy Masking
- ▶ Dual Streaming
- ▶ Alarm Relays
- ▶ IP67 and IK10
- ▶ ONVIF Compliant

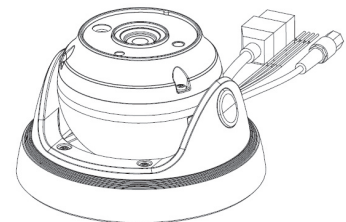

Ordering Information

Description

1080P network dome camera. IR LED (15m), 4mm Lens, 120 dB WDR, Dual Streaming, IP67. IK10. POE (6.2W)/12 VDC

Model Number

V992E-IR4-B

Model	V992E-IR4-B
Image Sensor:	IMX-136
Max Resolution:	1920 x 1080
Image Settings:	Adjustable bit rate. Flip and mirror. Configurable brightness, contrast, color, hue, sharpness. White balance. AGC. AES. Automatic or manual day/night mode. 3DNR, BLC (Backlight Compensation). Digital zoom. Motion detection. Slow Shutter. Privacy Masking
Shutter Speed:	1/4 ~ 1/5000 sec
Electronic Zoom:	2 ~ 100X (client software)
Day/Night Performance:	IR cut filter, True Day/Night
Wide Dynamic Range:	120 dB WDR
Minimum Illumination:	Colour: 0.63 lux (F3.5, 50IRE); B/W: 0.0 lux (IR LED ON)
Lens	
Focal Length:	4mm
Max. Aperture:	f/1.8
IR LED Distance	15m
Horizontal Field of View:	84°
Network Video Transmission	
Network:	10Base-T, 100Base-TX, RJ-45
Image Compression:	H.264 (High Profile) CBR/VBR; M-JPEG
Resolution:	1920x1080, 1280x720, 1280x1024, 1024x768, 704x480/576, 640x480, 352x240/288, 320x240
Protocol:	IPv4, TCP, HTTP, HTTPS, UPnP, RTSP/RTP/RTCP, IGMP, SNMP, DHCP, NTP, DNS, DDNS, UDP, ARP
Frame Rate:	1 ~ 30 fps
Multi-Streaming:	Dual (Stream1: H.264, Stream 2: H.264 or MJPEG)
Users:	Live viewing for up to 8 clients (unicast)
Web Browser:	Internet Explorer® 7.0 and above, Chrome®, Firefox®
Security:	IP address filtering, HTTPS encrypted data transmission, password protection
Mechanical and Electrical	
Construction:	Aluminum Die-casting, IP67, IK10
Mounting:	Surface mount.
Tilt and Horizontal Adjustment:	Pan: 360°; Tilt: 90° from vertical; rotation about its axis
Dimensions:	Body: 125mm (Φ) x 76.7mm (H); 83.3mm (Φ) dome bubble
Weight:	0.6 Kg
Input Power:	PoE (IEEE 802.3af Class 0), 12VDC
Power Consumption:	Max 6.3W (IR ON)
Alarm Relay	1 In; 1 Out
Environmental	
Operating Conditions:	Temp: -10 to 50° C; Humidity: less than 90%, non-condensing
Approvals:	FCC Class A, CE, UL
Warranty:	3 years

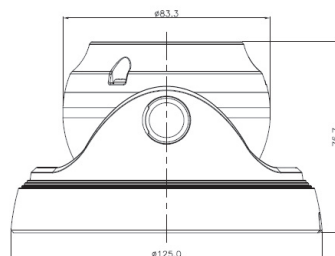

Data Sheet Number: V274-20
Dated: 7/2016

Vicon Data Sheet Part Number: 8009-7274-30-00
Specifications subject to change without notice.

Vicon and their logos are registered trademarks of Vicon Industries Inc.
Microsoft and Windows are registered trademarks of Microsoft Corporation.
Copyright © 2016 Vicon Industries Inc. All rights reserved.