

NOTES	SPEC NO.	REV.	SEC.
	795	997	6

PRODUCT SPECIFICATION

MODEL: V896MSH

PRODUCT CODE: 4005

DESCRIPTION: WEATHERPROOF MAXIMUM SECURITY HOUSING

- High resistance to vandalism
- Weatherproof
- Allows camera positioning
- Heater/defogger option available

The Vicon V896MSH Maximum Security Housing fills the need for a secure ceiling-mounted camera housing for high-risk applications.

Constructed of high-strength ten-gauge welded steel and a high-strength Lexan* viewing window, the V896MSH is capable of withstanding the most serious attempts of criminal or physical violence. Its high resistance to vandalism, coupled with its outdoor environmental design, make this maximum security housing ideal for parking garages, prisons, and sensitive installations not under constant patrol coverage.

The V896MSH is provided with a high-security cylindrical key lock coupled to a heavy-duty double claw closure system.

It can be mounted to a horizontal overhead support such as a ceiling, or it may be mounted to a vertical surface by using the V896MA mounting adapter.

NOTE: Since the V896MSH is heavy, any overhead support selected for it must be strong enough to support the weight of the housing.

The V896MSH permits internal adjustment of camera position without the need for accessory positioning devices.



V896MSH MAXIMUM SECURITY HOUSING

ASSOCIATED EQUIPMENT AND ACCESSORIES

Model V896MSH-H Heater/Defogger: Thermostatically- controlled option that consists of two blanket heaters mounted on radiator plates and a window heater. Operates at 120 V; provides 50 watts of heating power. Product Code 4180. Refer to Table 1.

Model V896MA Mounting Adapter: Used to mount the V896MSH housing to a vertical surface, such as a wall or pole. Product Code 4085.

CONTRACTORS' SPECIFICATIONS

Indoor/Outdoor Maximum Security Housing for Video Cameras

The housing shall be a maximum security environmental unit for small CCTV cameras and lenses. It shall be constructed of welded 10-gauge steel and have a 0.375-in. (0.95-cm) thick Lexan viewing window. The steel construction shall provide protection from radio frequency (RF) interference. It shall be provided with a tamperproof key-operated interactive lock for security. The housing shall be capable of ceiling mounting. The unit's maximum camera/lens combination shall be: length, 8.5 in. (21.6 cm); width, 3.25 in. (8.3 cm); depth, 3.5 in. (8.9 cm). The external dimensions shall be: length, 8.83 in. (22.4 cm); width, 7.50 in. (19.0 cm); depth, 12.75 in. (32.38 cm). The unloaded unit weight shall not exceed 18.75 lb (8.5 kg). The housing shall be Vicon's model V896MSH.

TECHNICAL INFORMATION

ELECTRICAL

Cable Access: Two 0.8125-in. (2.064-cm) diameter openings provided so cabling is not exposed.

OPTICAL

Light Loss Through Window: Negligible.

OPERATIONAL

Field-of-View Adjustments: Camera position may be adjusted horizontally and vertically in housing.

Locking System: Heavy-duty high-security lock combined with second key-operated double-claw latching system.

MECHANICAL

External Dimensions: Height (H): 8.83 in. (22.4 cm).
Width (W): 7.50 in. (19.0 cm).
Depth (D): 12.75 in. (32.38 cm).

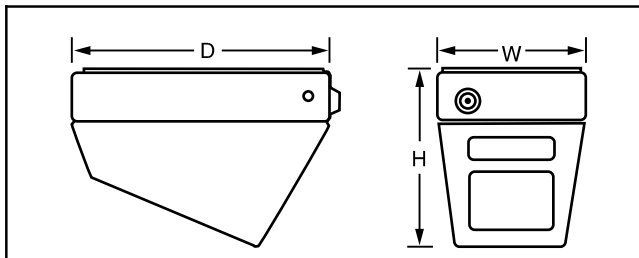

Weight: 18.7 lb (8.5 kg).

Maximum Camera/Lens Dimensions: Length: 8.5 in. (21.6 cm).
Width: 3.25 in. (8.3cm).
Height: 3.5 in. (8.9cm).

Construction: Housing: welded 10-gauge steel.
Camera window: 0.375-in. (0.95-cm) thick Lexan*.

Clear Window Area: 3.4 × 4.5 in. (8.6 × 11.4cm).

Finish: Interior: black paint.
Exterior: cast-iron gray.

Mounting: Housing: four (4) holes for ceiling mounting.
Camera: mount adjustable in four directions (swivel tilt up/down and forward/rearward).

Shipping Dimensions: Height: 9.0 in. (23 cm)
Width: 9.5 in. (24 cm).
Depth: 14.0 in. (35.6 cm).

Shipping Weight: 19.0 lb (8.6 kg).

Shipping Volume: 0.7 ft³ (0.02 m³).

ENVIRONMENTAL

Ambient Temperature Range: -10 to 110° F (-23 to 43.3° C) with V896MSH-H option.

***NOTE ON POLYCARBONATE WINDOWS:** Lexan polycarbonate plastic is one of the best and strongest of modern plastics. However, virtually all plastics, including polycarbonates, can be etched by exposure to various types of solvents. Do not place this housing in locations where such solvents may be in the air in high concentrations.

**TABLE 1
HEATER SPECIFICATIONS**

Model Number	Input Voltage (V)	Current (A)	Power Consumption (Max) (W, VA)	Heat Equivalent** (btu/min (cal/min))	Weight (lb (kg))
V896MSH-H	120	0.42	50	2.8 (0.72)	0.5 (0.2)

**Note: The heat equivalent represents the conversion of 100% of the electrical energy to heat. The actual percentage of heat generated will be less and will vary from product to product. These figures are provided as an aid in determining the extent of cooling required for an installation.