



CCTV

SISTORE AX –
get the images you need



Answers for infrastructure.

SIEMENS



Simple and secure – with digital technology

SISTORE AX offers all the advantages of digital video surveillance in a single compact unit. Developed for smaller applications, SISTORE AX can be used anywhere for recording up to 16 cameras, for example in petrol stations, small shops, supermarkets, museums etc. Quick and easy to install, SISTORE AX is particularly simple to operate. Flexible control, efficient H.264 compression, easy access to recorded images and powerful search functions ensure that you always get the images you need.

SISTORE AX – Key features

■ High-quality images

The latest version of SISTORE AX utilizes H.264 video compression technology, which delivers higher-quality images, smaller file sizes and better streaming over limited bandwidth connections.

■ Easy operation

The graphical user interface of the SISTORE AX is very easy to configure and use, with a very logical menu structure. As a result, training requirements are minimal.

■ Direct unit control and PTZ capability

The SISTORE AX has an easy-to-use front panel for direct unit control. Most SISTORE AX models can control both dome and PTZ cameras via the unit front panel buttons. This includes the storing and recall of camera presets.

■ Remote access via RAS, Internet or Smartphone

All SISTORE AX models include licence-free remote administration software (RAS), which can be used to retrieve and view images from one or more remote workstations. (Two-way audio functionality is also available via RAS.) New SISTORE AX models can also be remotely accessed via a standard Web browser. SISTORE AX RAS Mobile enables remote access from a Windows Mobile based Smartphone or PDA.

■ True archiving flexibility

In addition to storing video images on its internal hard drive, the SISTORE AX can archive data to the built-in DVD drive and external devices, such as USB memory

sticks and external hard drives. The new standard SISTORE AX device provides 1TB of HDD capacity, while the new 8/16 channel devices are capable of being expanded up to a total capacity of 3TB. The high HDD capacity combined with the H.264 compression make it possible to achieve significantly longer storage times.

■ Real-time or real-half-time recording

All SISTORE AX models can now provide real-time recording for all connected cameras. The new AX4 Lite model has a maximum global recording speed of 100ips, the new AX8 model provides 200ips, and the new AX16 model provides 400ips. The SISTORE AX also offers a high level of flexibility in configuring camera recording rates, particularly when recording at very high (4CIF) and high (2CIF) resolutions. In particular, this can allow real-time or half-real-time recording on selected cameras at these resolutions.

■ Selectable VGA resolution

SISTORE AX has three VGA resolution options selectable via the on-screen menu. The optimum VGA resolution can be selected to best match the LCD VGA monitor being used with the device.

■ Easy integration with SiPass access control systems

SISTORE AX can be connected directly to SiPass Entro or SiPass integrated access control systems – full interoperability is built in as standard.

Highlights

- Remarkable image quality
- Optimised storage capacity utilising H.264 technology
- Easy configuration and operation
- Viewing and searching using a standard Web browser and RAS software
- Flexible archiving options

Museums

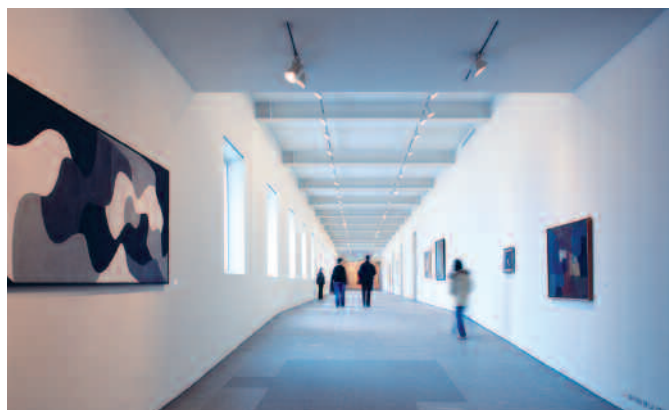

Small shops





CKA4820 Remote keyboard control

SISTORE AX – simple and flexible

■ **Record for more than a month in a single unit**

Utilising H.264 technology enables even the smallest SISTORE AX4 Lite unit with four cameras to record images continuously for more than a month. The recorded data is protected against tampering with a digital signature so that the authenticity of each recorded image can be verified.

■ **Recording modes**

SISTORE AX can provide an optimised recording mode for any situation. Both recording speed and image quality can be increased in response to an external

alarm input or built-in activity detection, therefore recording more information. During standard time-lapse recording both image quality and recording speed can be decreased to reduce the storage space required, therefore optimising achievable recording times.

Furthermore, if a video signal loss alarm occurs on a camera, the SISTORE AX can start recording an additional camera in the same room. This allows the cause of the video loss to be determined quickly and easily.

Highlights

- Efficient video compression with H2.64 technology
- RAS mobile allows remote access for live viewing of Windows-based smartphones and PDAs
- Optimised recording time using multiple recording modes
- Quick and easy searching

SISTORE AX Watch

Enables image live viewing by drag&drop of the camera to the desired screen location. Status display of SISTORE AX remote devices and site plan functionality allow full control of the system.

SISTORE AX Search

Enables search and replay of recorded images via RAS using time periods and particular events.

SISTORE AX Player

Enables images to be replayed after checking the encryption.



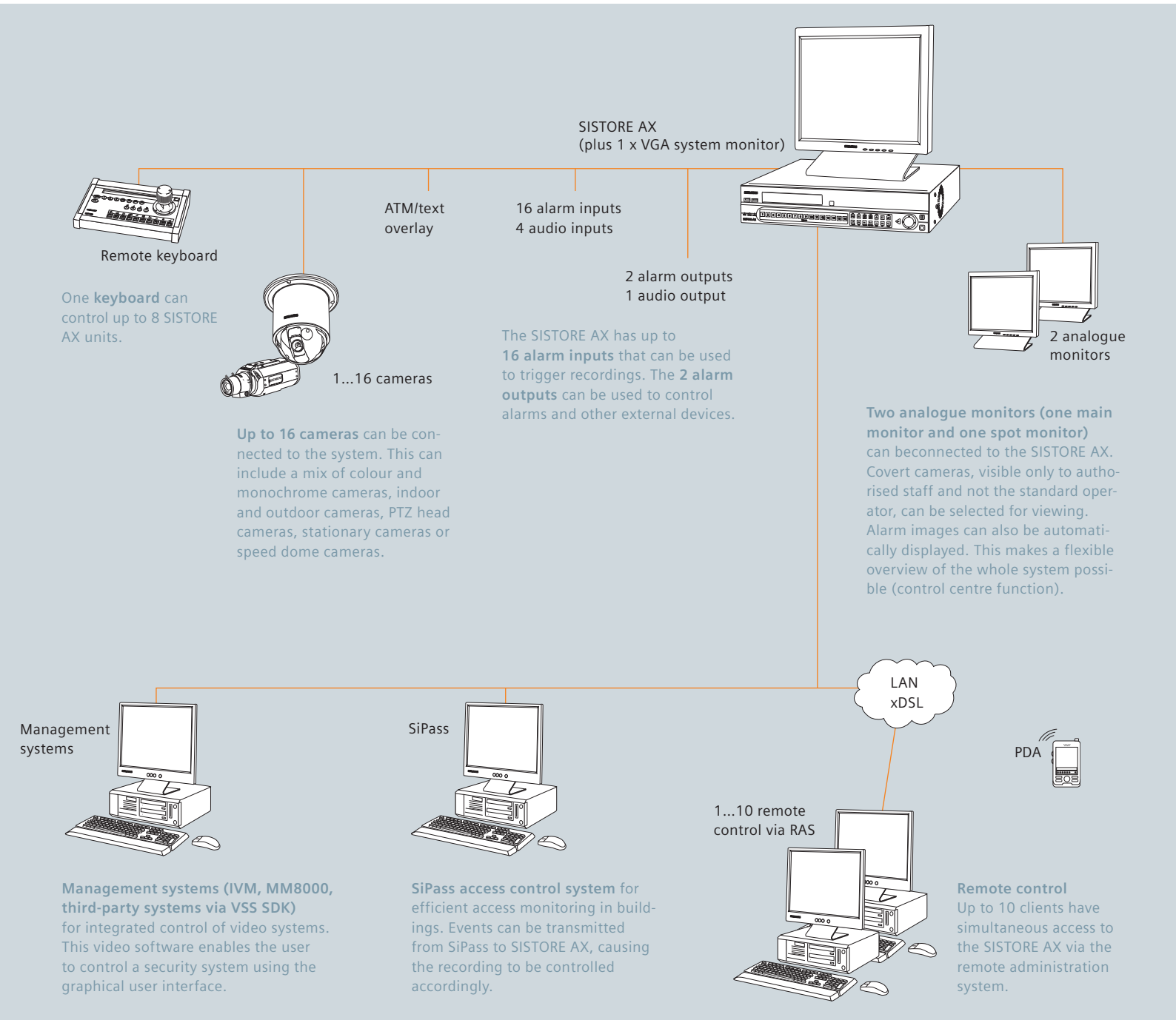

Pre-event recording can be configured to allow better determination of what led to an event, by recording images of the event itself as well as immediately beforehand.

■ **Flexible searching**

The powerful search functions of the SISTORE AX help you find the images you need quickly. Searching is possible using time and date, by particular events and

by individual camera. With the museum search function it is possible to search for footage in which particular objects (such as vases or paintings) have been moved from their place. Simply placing a box around the relevant area allows quick and easy searching. Video loss events and text entries from cash registers can also be used as search criteria, therefore providing powerful search flexibility.



SISTORE AX – Additional features

■ Transaction devices

SISTORE AX can be connected to a transaction device, such as an ATM or a point-of-sale (POS) system. This allows detailed transaction information to be recorded with the relevant video and used as supplemental information and for searching.

■ Audio recording

Each model of the SISTORE AX V4 family allows audio recordings for up to four audio channels. Two-way audio functionality is available when SISTORE AX RAS is used.

■ Assigning rights

SISTORE AX ensures the highest security and flexibility when accessing the system via configurable administration rights.

■ Dual encoding

The transmission rate and image quality for streaming to the remote client can be configured independently of the local recording rate and quality. This enables the transmission of video images with lower bandwidth to match existing network infrastructure limitations without affecting local recording.

■ Covert camera mode

Any camera can be recorded, but whether or not the output is displayed depends upon upon the user level, so cameras monitoring cash registers could only be monitored by managers, for example.

■ Panic button

SISTORE AX offers “panic button” recording to provide better support of security personnel. Pressing the panic button in suspicious situations starts recording all cameras at the independently configurable panic mode. This allows the lower quality and frame rate of time-lapse recording to automatically switch to a higher quality and frame rate during a panic-recording situation.

■ Self-diagnosis (temperature monitoring)

The self-diagnosis function is based on the S.M.A.R.T. protocol (self-monitoring analysis and reporting technology). It ensures the SISTORE AX is even more fail-safe. If a malfunction of the hard drive occurs or a specified temperature limit value is exceeded, SISTORE AX automatically triggers an alarm or sends a message. The callback function allows the unit to connect to the remote client using an existing network or dial-up and to report the problem, therefore allowing the operator to take corrective measures.

Highlights

- Detailed information via connection to transaction devices
- Two-way audio functionality
- Audio recording
- Configurable administration rights
- “Panic button” for a better support of security personnel

Technical overview

	SISTORE AX4 Lite 1000/100	SISTORE AX8 1000/200	SISTORE AX16 1000/400
			
Display			
Video inputs (loop-through)	4	8	16
Monitor outputs	1x system monitor 1x VGA: 800x600, 1024x768, 1280x1024 (60 Hz)	1x system monitor, 1x spot 1x VGA: 800x600, 1024x768, 1280x1024 (60 Hz)	1x system monitor, 1x spot 1x VGA: 800x600, 1024x768, 1280x1024 (60 Hz)
Audio inputs/outputs	4/1	4/1	4/1
Freeze/zoom image	■	■	■
Live display formats	1 (full screen), 2x2 (quad)	1 (full screen), 2x2 (quad), 3x3 (mono)	1 (full screen), 2x2 (quad), 3x3 (mono), 4x4 (hex)
Covert camera mode	■	■	■
Recording			
Compression	H.264	H.264	H.264
Resolutions	CIF/2CIF/4CIF	CIF/2CIF/4CIF	CIF/2CIF/4CIF
Maximum recording speed – no local playback	100 ips	200 ips	400 ips
Panic button (recording)	■	■	■
Triplex mode	No (duplex)	■	■
Alarms			
Alarm inputs and outputs	4 and 1	8/2	16/2
Video loss detection	■	■	■
Activity detection	192 zones	768 zones	768 zones
Internal buzzer	■	■	■
Alarm log	■	■	■
Watchdog alarm	■	■	■
S.M.A.R.T. self-diagnosis	■	■	■
HDD			
Supported HDD	SATA 250/500/1000GB	SATA 250/500/1000GB	SATA 250/500/1000GB
Operation			
PTZ/dome control	front panel, RAS, web view, mouse, remote control	front panel, RAS, web view, mouse, remote control	front panel, RAS, web view, mouse, remote control
Fast forward/rewind control	3 speed levels adjustable	3 speed levels adjustable	3 speed levels adjustable
Password protection	Customisable, 64 user groups, 256 users per group	Customisable, 64 user groups, 256 users per group	Customisable, 64 user groups, 256 users per group
Remote keyboard control	■	■	■
Infrared remote control or mouse	■	■	■
Web browser access	■	■	■
Remote access via mobile/RAS (licence-free)	■	■	■
Connection options			
Ethernet/LAN/WAN (10/100 Mbps)	■	■	■
Remote control via RAS (licence-free)	■	■	■
Text overlay interface (ATM, POS)	■	■	■
Export/backup			
Export of images via network	Clip-Player, AVI	Clip-Player, AVI	Clip-Player, AVI
Image backup/archive	via USB	via USB/DVD writer (int.)	via USB/DVD writer (int.)
Hard disk expansion possibility	–	■	■

Answers for infrastructure.

■ Megatrends driving the future

The megatrends – demographic change, urbanization, climate change, and globalization – are shaping the world today. These have an unprecedented impact on our lives and on vital sectors of our economy.

■ Innovative technologies to answer the associated toughest questions

Throughout a 160-year history of proven research and engineering talent, with more than 50,000 active patents, Siemens has continuously provided its customers with innovations in the areas of healthcare, energy, industry, and infrastructure – globally and locally.

■ Increase productivity and efficiency through complete building life cycle management

Building Technologies offers intelligent integrated solutions for industry, commercial and residential buildings, and public infrastructure. Over the entire facility's life cycle, our comprehensive and environmentally conscious portfolio of products, systems, solutions, and services for low-voltage power distribution and electrical installation technology, building automation, fire safety and security ensures the:

- optimum comfort and highest energy efficiency in buildings,
- safety and security for people, processes, and assets,
- increased business productivity.



Siemens AB
Security Products
International Headquarters
Englundavägen 7
Box 1275
17124 Solna
Sweden
Tel: +46 8 629 0300

Siemens plc
Security Products
Brecon House
Llantarnam Park
Cwmbran
South Wales
NP44 3AB
United Kingdom
Tel: +44 871 386 0800

The information in this document contains general descriptions of technical options available, which do not always have to be present in individual cases. The required features should therefore be specified in each individual case at the time of closing the contract.

© Siemens AB, 2010.