

Stainless Steel Camera Housing

254 Series

AISI316L Stainless Steel construction
For use in highly corrosive environments
Easy installation and maintenance
Wiper version available
Weatherproof standard IP67
Suitable for very big zoom lenses



■ 254
Stainless steel camera housing

- It's really hard to find a camera housing which can both protect from aggressive environment and suit very big lenses and cameras. In this case, 254 Series is the best choice. The outer body diameter measures 10 inches (254mm) and can be 600 or 700 mm long. This is the biggest size available on the market and it's the only stainless steel housing solution for biggest zoom lenses, such as Raymax "CATS 2000", Myutron PH33X16HS-RGE, Fujinon C22 and D60 series, Pentax H20ZAME and H55ZAME series, Kowa LMZ1000AM and its high quality is unique, like its 200 mm usable front window diameter.

The housing is made in AISI316L stainless steel, therefore it guarantee absolute reliability and protection in every environmental condition, even the worst. The stainless steel bracket is conceived to reduce vibrations and to keep the housing still in most windy places and for those special applications that require the absence of any vibrations. Install and maintenance tasks are really easy.



■ 254
Internal view

Available accessories and versions:

- Sunshield and thermostatically controlled heater
- Wiper system
- Germanium front windows available for thermal imaging cameras
- A full range of washer tanks (WP and WP-SSC Series)
- SSBK254: wall mounting bracket with swivel joint
- SSPM254: pole mount adapter

Technical Specifications



MODELS

254 ¹	Housing (Length=600mm)
254-L ¹	Housing (Length=700mm)
254SH ¹	Housing (600mm) + Sunshield + Heater
254SH-L ¹	Housing (700mm) + Sunshield + Heater
254WW ²	Housing (600mm) + Sunshield + Heater + Wiper
254WW-L ²	Housing (700mm) + Sunshield + Heater + Wiper
254IR155 ³	Housing (600mm)
254IR155-L ³	Housing (700mm)
254SHIR155 ³	Housing (600mm) + Sunshield + Heater
254SHIR155-L ³	Housing (700mm) + Sunshield + Heater
254WWIR155 ³	Housing (600mm) + Sunshield + Heater + Wiper
254WWIR155-L ³	Housing (700mm) + Sunshield+ Heater + Wiper

- ¹ Usable front windows diameter: 200 mm; thickness 5mm.
² Usable front window diameter: 200 mm; vandal resistant glass 12 mm thickness
³ Usable front window diameter: 155 mm; Germanium window, thickness 5 mm, AR/DLC coating.

Note: all models are available also in 500 mm length, we are also ready to fulfil any particular request such as different housing length or different glass diameter

GENERAL & MECHANICAL

Construction: AISI316L Stainless Steel
Finish: Electro-polished
Operating Temperature: -20° +55°C (-4° +131° F)
Dimensions: See drawings next page

Weight [kg]		
Model	Unit	Package
254	22	27
254-L	24	29
254SH	25	30
254SH-L	27	32
254WW	26	32
254WW-L	28	35

ELECTRICAL

Thermostatically controlled Heater:
T[°C] ON = 15 ± 4°C, T[°C] OFF = 23 ± 3°C
 Available voltages: 24VDC, 24VAC, 110VAC, 240VAC (specified at order)
 Power consumption: 25W

Wiper:
 Available voltages: 24VDC (4W), 24VAC (8W), 110VAC (8W), 240VAC (8W) (specified at order)

Cable Entry:
 4 M20x1,5 nickel plated brass cable glands (included).
 Standard cable diameter 6-10mm. Different cable entries are available to meet every installation requirement.

CERTIFICATIONS

Weatherproof standard: IP67
 CE Compliant

RECOMMENDED ACCESSORIES

SSBK254	AISI316L Stainless Steel wall mounting bracket with swivel joint
SSPM254	AISI316L Stainless Steel Pole Mount adapter

MOUNTING

RECOMMENDED SPARE PARTS AND ACCESSORIES

WB254	Complete wiper blade assembly
WBK254	Wiper blade spare part (only rubber blade and support)
HK254	Heater Kit 25W (24VDC, 24VAC, 110 VAC or 240 VAC available)
MK254	Maintenance Kit with O-ring seals, screws seals, screws, hex keys, cable glands (2), desiccant bags

RECOMMENDED WASHER PUMPS

A wide range of water reservoirs with different pumping height capabilities is available.

WP Series (tanks with stainless steel frame)

WP5-5m	5 Litres tank, 5 metres delivery head
WP5-10m	5 Litres tank, 10 metres delivery head
WP10-5m	10 Litres tank, 5 metres delivery head
WP10-10m	10 Litres tank, 10 metres delivery head
WP25-5m	25 Litres tank, 5 metres delivery head
WP25-10m	25 Litres tank, 10 metres delivery head
WP25-15m	25 Litres tank, 15 metres delivery head

WP-SSC Series (tanks with stainless steel cabinet)

WP5-10m-SSC	5 Litres tank, 10 metres delivery head
WP10-10m-SSC	10 Litres tank, 10 metres delivery head
WP25-10m-SSC	25 Litres tank, 10 metres delivery head
WP25-15m-SSC	25 Litres tank, 15 metres delivery head

Dimensions

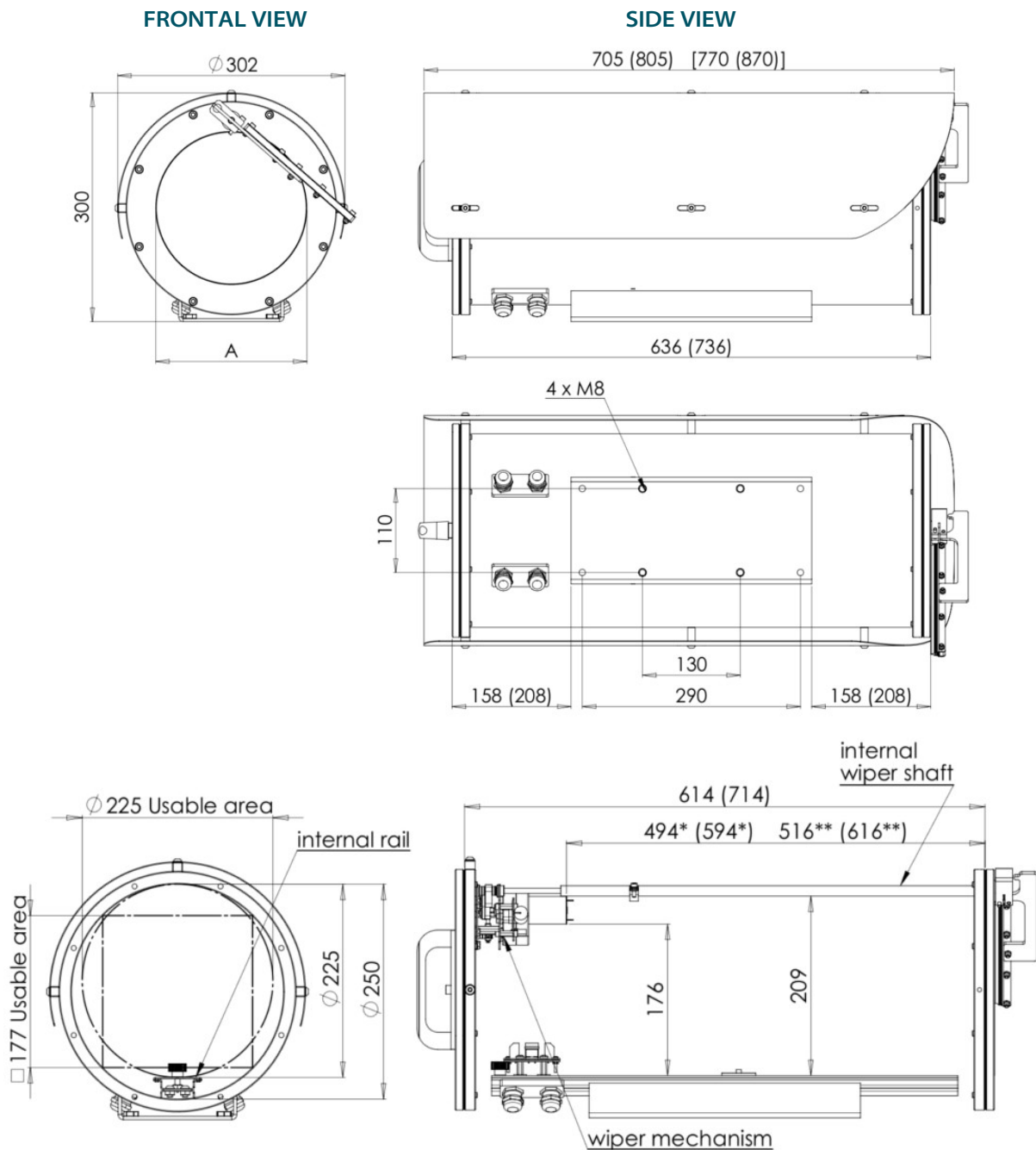

Dimensions in brackets refer to models 254 with 700 mm tube length.
Dimensions in square brackets refer to sunshield of wiper models.

Available measures for "A"

A = **200** mm for 254, 254-L, 254SH, 254SH-L, 254WW and 254WW-L

A = **155** mm for 204IR155, 254IR155-L, 254SHIR155, 254SHIR155-L, 254WWIR155 and 254WWIR-L (germanium window)

* Length measure for models with sunshield, heater and wash wiper

** Length measure for models with sunshield and heater