



PM14 Mount

WALL MOUNT, LIGHT DUTY, PAN/TILT

Product Features

- Low Cost Wall Mount
- Decorator Styling
- Supports up to 20 Pounds (9.07 kg)
- Accommodates Light Duty Pan/Tilts
- Can Be Adapted for Pole Applications With Use of PA101 Adapter



The **PM14** is a light duty pan/tilt mount designed for wall mount applications.

The **PM14** is manufactured from aluminum and die-cast for low cost efficiency. The **PM14** will support up to 20 pounds (9.07 kg).

The mount can be used with our PT270/PT280 Series pan/tilts.

The **PM14** can also be adapted for pole mount applications when used with the PA101 mount adapter.

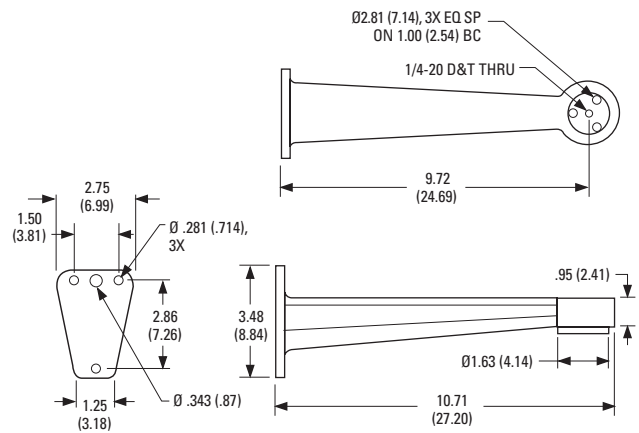

NOTE: VALUES IN PARENTHESES ARE CENTIMETERS; ALL OTHERS ARE INCHES.



DataFAX
SPEC: 2215
MANUAL: 22156

C215 / REVISED 10-01



International Organization
for Standardization;
Registered ISO 9001



TECHNICAL SPECIFICATIONS

MODEL

PM14

Light duty wall mount for PT270P, PT270-24P, and PT280-24P pan/tilts or light-weight enclosures

RELATED PRODUCTS

PA101

Pole mount adapter for PM14 mount.
Minimum pole diameter 3 inches (7.62 cm).
Stainless steel straps supplied. Strap length 28.5 inches (72.39 cm)

MECHANICAL

Pan/Tilt Mounting
PT270/PT280

Mounting Method

Three 1/4-20 x 1.25 cap screws (supplied)
Secure to solid surface with three 1/4-inch diameter fasteners or use two fasteners (one 1/4-inch diameter and one 5/16-inch diameter) for center mounting holes in applications where wall studs are encountered. (Fasteners not supplied)

GENERAL

Construction

Die-cast aluminum

Finish

Gray polyester powder coat

Suggested

Maximum Load

20 lb (9.07 kg)

Unit Weight

PM14

1 lb (0.45 kg)

PA101

0.88 lb (0.40 kg)

Shipping Weight

PM14

2 lb (0.90 kg)

PA101

2 lb (0.90 kg)

CERTIFICATIONS

- UL Listed

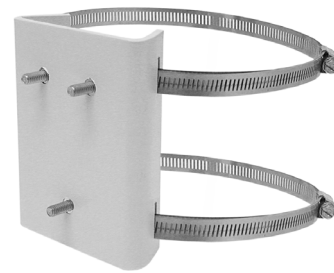

PA101 POLE ADAPTER MOUNT

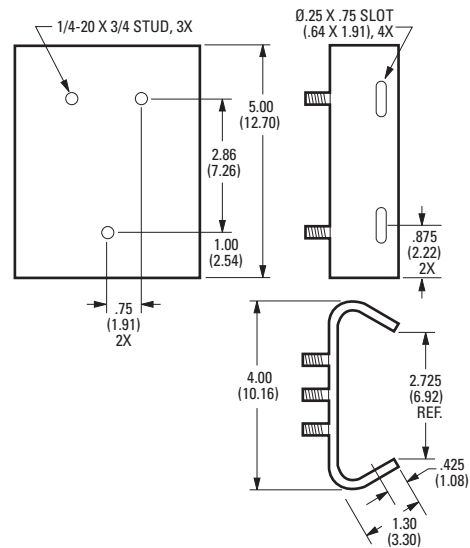

NOTE: VALUES IN PARENTHESES ARE CENTIMETERS;
ALL OTHERS ARE INCHES.

PA101 DIMENSION DRAWING



Pelco Worldwide Headquarters:

3500 Pelco Way, Clovis, California 93612-5699 USA

USA & Canada Tel: (800) 289-9100 • FAX (800) 289-9150 • DataFAX (800) 289-9108

International Tel: (559) 292-1981 • FAX (559) 348-1120 • DataFAX (559) 292-0435

www.pelco.com

Specifications subject to change without notice.
©Copyright 2001, Pelco. All rights reserved.