



LILIN S Series cameras – SR7022 is best-in-class IP camera, designed for a variety of outdoor and indoor applications. From LILIN's powerful latest technology, the S Series cameras have an ultra fast frame rate of 60 FPS at 2 megapixel 1080P resolution, this results in crystal clear images. Its IP66-rated housing protects the SR7022 camera body against dust and rain. IP66 rating ensures operation under harsh weather conditions. Cameras are incorporated with a progressive scan MOS sensor with 0.03 lux at F1.6 low light mode capability, S Series camera – SR7022 is able to capture fast moving objects during daytime and nighttime. The S Series cameras support high performance H.264 and Motion JPEG compression technology, and offers smooth video quality up to 60 FPS at 1080P. Using 60 FPS at 2 megapixel 1080P resolution, can be particularly beneficial when viewing moving objects to ensure pictures are kept sharp.

FEATURES :

- Full HD 2.0 megapixel MOS image sensor
- 60 FPS @ 1080P True H.264 AVC High Profile video compression
- H.264 and Motion JPEG multi-profile video streaming
- 3D Noise Reduction (MCTF)
- HDR function up to 120dB
- Defog function
- Digital PTZ supported
- Tampering / Motion detection alarm function
- High efficiency IR LED, radiant distance up to 30m
- Day & Night (IR cut removable)
- ONVIF supported

DIMENSIONS : (Unit : mm)

Body : 82(W) x 72.5(H) x 154(D) Bracket: 101(L)

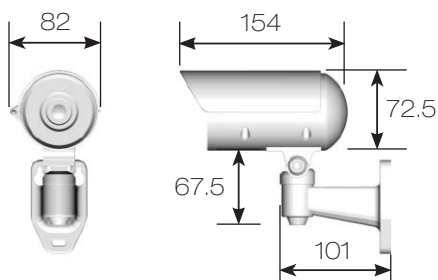

INSTALLATION HOLE SITE DIAGRAM :

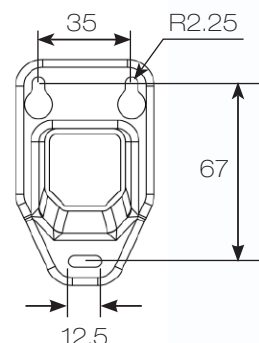

SPECIFICATION :

Name		Day & Night 1080P 60 FPS HD IR IP Camera		
Model		SR7022E4	SR7022E6	
Lens	Focal length	4 mm	6 mm	
	Iris	F1.6	F1.8	
	Angle of view	H	84°	57.6°
		V	45.2°	31.4°
D		100.6°	67.3°	
Pick Up Element		1/2.86" MOS image sensor		
Effective Pixels		1952 (H) x 1266 (V) = 2,471,232 (pixels)		
Scanning System		Progressive Scan		
Infrared Cut Filter		Auto / Schedule / Day (Color) / Night (Mono)		
Min. Illumination		0.03 Lux at F1.6 (Low Light Mode) , 0 Lux with IR LED ON	0.05 Lux at F1.8 (Low Light Mode) , 0 Lux with IR LED ON	
White balance		Auto / Tungsten / Indoor / Fluorescents1 / Fluorescents2 / Outdoor1 / Outdoor2		
Back light compensation		Off / On		
Electrical Shutter		1/30(1/25)s - 1/30000s		
Sense up		Off / 1 Frame / 2 Frames		
Sense up +		Yes		
Auto gain control		54 dB Variable Gain		
3D Noise Reduction		Off / 1 - 32 Selectable		
2D WDR		Off / Auto / x2 / x3 / x4 (by normal mode)		
High Dynamic Range		Up to 120dB (by HDR mode, 2 shutter line interleave)		
Privacy Masking		Off / On (4 zones)		
Image Effects		Brightness, Contrast, Hue, Saturation, Sharpness, Mirror, Flip, Defog		
IP Rating		IP66		
Window		Ø65 Heat Resistant Glass		
Infrared LED	Peak wavelength	850nm		
	Beam spread	30°		
	Radiant distance	30M		
Operating Temperature		-40°C - +50°C (-40°F - 122°F)		
Dimension		Body : 82mm(W) x 72.5mm(H) x 154mm(D) / Bracket : 101mm(L)		
Weight		600g		
Power Supply		DC12V ±10% / PoE (IEEE 802.3af compliant)		
Power Consumption		DC12V, 10W / PoE, 11W		

Network		
Video compression		H.264 Main and High Profile , Motion JPEG
Resolution		1080P(1920x1080), 720P(1280x720), D1(720x480), CIF(352x240)
Multiple profile	Profile #1	Dual-stream mode, H.264 : up to 60 FPS @ 1920 x 1080, Motion JPEG : up to 30 FPS @ 720 x 480
	Profile #2	HDR mode, H.264 : up to 30 FPS @ 1920 x 1080 , Motion JPEG : up to 30 FPS @ 720 x 480
Video streaming		RTP/HTTP, RTP/TCP, RTP/UDP, Multicast
Video bitrate		128Kbps - 12Mbps Frame rate and bit rate controllable on-the-fly VBR / CBR / GOP supported
Security		Base64 HTTP encryption Multiple user access levels with password protection 10 user accounts available
Users		8 simultaneous users
ePTZ & digital zoom		Yes, ROI is supported
OSD		Text overlay for date, time, and camera name
Alarm functions		Motion / tampering detection triggering recording into SD card Image upload over FTP and E-mail by tampering / motion detection
CPU, memory		Embedded SoC, 1.2GHz Dual ARM Cortex-A9 & 600MHz ARM11, 1GB DDR3, 256MB flash memory
Maintenance		Firmware update via HTTP Firmware available at web site
Network interface		10/100/1000 Mbps Base-T, RJ-45
PC requirement		OS : Windows 2000, Windows XP, Windows Vista, Windows 7, Windows 8 Browser : Windows Internet Explorer 6.0 or above CPU : Intel Core 2 Duo E6400 2.13GHz or above RAM : 2GB or above, Independent Display Card
Network protocols		IPv4, IPv6, TCP, UDP, HTTP, SMTP, NTP, DDNS, UPnP, FTP, ARP, DHCP, PPPoE, DNS, RTSP, RTCP, Telnet, ICMP, IGMP, ONVIF Profile S, SNMP, SIP, Bonjour
Mobile phone and PDA		iPhone, iPad, and Android support
System Integration		ONVIF & LILIN HTTP API
Central management system		NAV 1.0 support
Video display		LILIN Universal ActiveX & LILIN Java Applet
OS		Embedded Linux 3.8.0
SD card recording		Support Micro SD/SDHC/SDXC card for circular recording (card is not included)