



As with all Pro series cameras, the Day & Night 3MP HD IR IP camera IPR732 incorporates Sense up+, a unique technology that successfully delivers stunning video in low-light conditions. Featuring high-efficiency IR-LEDs provide 30 meters of light. Utilizing intelligent image signal processing, AGC control, and 3D Noise Reduction, this model successfully delivers the ultimate low-light image without motion blur. The IPR732 is capable of producing four independent video streams, different streams can be set for different applications, depending on the individual user requirements. The IP66-rated housing is designed to help the camera body withstand rain and dust and ensures operation under a multitude of harsh weather conditions.

FEATURES :

- Full HD 3.27 megapixel CMOS image sensor
- True H.264 AVC/MPEG-4 part 10 real-time Video compression
- H.264 and Motion JPEG multi-profile Video streaming
- 3D Noise Reduction (MCTF)
- 2D WDR function
- Digital PTZ supported
- Face / Tampering / Motion detection
- High efficiency IR LED, Radiant distance up to 30m
- Day & Night (IR cut removable)
- ONVIF supported
- Digital I/O : 1 in, 1 out
- ONVIF supported

DIMENSIONS : (Unit : mm)

Body : 82 x 72.5 x 154(W x H x D) Bracket: 101(L)

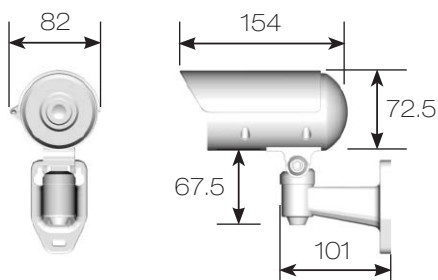

INSTALLATION HOLE SITE DIAGRAM :

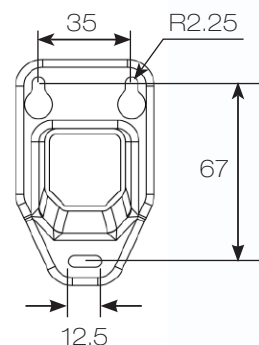

SPECIFICATION :

Name		Day & Night 3MP HD IR IP Camera		
Model		IPR732ES4.3	IPR732ES6	
Lens	Focal length	4.3 mm	6 mm	
	Iris	F1.6	F1.8	
	Angle of view	H	70°	49.3°
		V	51°	35.9°
D		89°	64.5°	
Pick up element		1/2.8" CMOS image sensor		
Effective pixels		2096 (H) x 1561 (V) = 3,271,856 (pixel)		
Scanning system		Progressive scan		
Infrared cut filter		Auto / schedule / day (color) / night (mono)		
Min. illumination		0.25 Lux at F1.6 (Low light mode) / 0 Lux with IR LED on	0.3 Lux at F1.8 (Low light mode) / 0 Lux with IR LED on	
White balance		Auto / tungsten / indoor / fluorescents1 / fluorescents2 / outdoor1 / outdoor2		
Back light compensation		Off / on		
Electrical shutter		1/30(1/25)s - 1/8000s		
Sense up		Off / 1 frame / 2 frames / 3 frames / 7 frames		
Sense up +		Yes		
Auto gain control		36 dB variable gain		
3D Noise Reduction		Off / 1 - 32 selectable		
2D WDR		Off / auto / x2 / x3 / x4		
Privacy masking		Off / on (4 zones)		
Image effects		Brightness, contrast, hue, saturation, sharpness, mirror, flip		
IP rating		IP66		
Window		Ø65 heat resistant glass		
Infrared LED	Peak wavelength	850nm		
	Beam spread	30°		
	Radiant distance	30M		
Operating temperature		-40°C - +50°C (-40°F - 122°F)		
Dimension		Body : 82mm(W) x 72.5mm(H) x 154mm(D) / Bracket : 101mm(L)		
Weight		600g		
Power supply		DC12V ±10% / PoE (IEEE 802.3af compliant)		
Power consumption		DC12V, 9W / PoE, 10.2W		
Network				
Video compression		H.264 , Motion JPEG		
Resolution		3MP(2048 x 1536), 1080P(1920 x 1080), 720P(1280 x 720), D1(720 x 480), CIF(352 x 240)		
Multiple profile	Profile #1	H.264 : up to 30 FPS @ 1920 x 1080, MJPEG : up to 30 FPS @ 720 x 480		
	Profile #2	H.264 : up to 30 FPS @ 1280 x 720, MJPEG : up to 30 FPS @ 352 x 240		
	Profile #3	H.264 : up to 30 FPS @ 1920 x 1080, MJPEG : up to 30 FPS @ 1280 x 720		
	Profile #4	H.264 : up to 30 FPS @ 720 x 480, MJPEG : up to 15 FPS @ 1920 x 1080		
	Profile #5	H.264 : up to 15 FPS @ 2048 x 1536, MJPEG : up to 15 FPS @ 720 x 480		
Video streaming		RTP/HTTP, RTP/TCP, RTP/UDP, Multicast		
Video bitrate		128Kbps - 8Mbps Frame rate and bit rate controllable on-the-fly VBR / CBR / GOP supported		
Security		base64 HTTP encryption Multiple user access levels with password protection 10 user accounts available		
Users		8 simultaneous users		
ePTZ & digital zoom		Yes, ROI is supported		
OSD		Text overlay for date, time, and camera name		
Alarm function		Motion / tampering / face detection triggering recording into SD card Image upload over FTP and E-mail by face / tampering / motion detection		
CPU, memory		Embedded SoC ARM11, 528MHz, 256MB DDR2, 256MB flash memory		
Maintenance		Firmware update via HTTP Firmware available at web site		
Network interface		10Mbps / 100Mbps Base-T, RJ-45		
PC requirement		OS : Windows 2000, Windows XP, Windows Vista, Windows 7, Windows 8 Browser : Windows Internet Explorer 6.0 or above CPU : intel pentium 4 1.8GHz or above RAM : 1GB or above, independent display card		
Network protocols		IP, TCP, UDP, HTTP, SMTP, NTP, DDNS, UPnP, FTP, ARP, DHCP, PPPoE, DNS, RTSP, RTCP, Telnet, ICMP, IGMP, ONVIF Profile S, SNMP, SIP, Bonjour		
Mobile phone		iPhone, iPad, and Android support		
System integration		ONVIF & LILIN HTTP API		
Central management system		NAV 1.0 support		
Video display		LILIN Universal ActiveX & LILIN Java Applet		
OS		Embedded Linux 2.6.32		
SD card recording		Support Micro SD/SDHC card for circular recording (card is not included)		