



CS3514M

■ Specifications

Model	CS3514M	CS3514D
Image Format	1/3" CCD	1/3" CCD
Focal Length	3.5~8mm	3.5~8mm
Zoom Ratio	x2.3	x2.3
Mount (Flange Back)	CS Mount (12.5mm)	CS Mount (12.5mm)
F NO.	1.4	1.4
Angle of View [Diagonal]	92°~43°	92°~43°
Min. Object Distance	0.5m	0.5m
Lens Construction	7Groups 9Elements	7Groups 9Elements
Iris	Manual Iris	DC Iris
Dimension (Dia x W)	ø36x59.1	ø38x59.1
Weight	106.7g	125g

■ Feature

- CS mount
- Vari-focus : 3.5~8.0mm
- Manual iris



CS3514D

■ Feature

- CS mount
- Vari-focus : 3.5~8.0mm
- Auto (DC) iris

■ Rear View



CS3514M



CS3514D

■ Dimension (unit : mm)

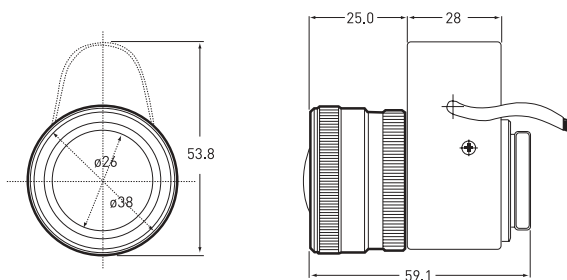
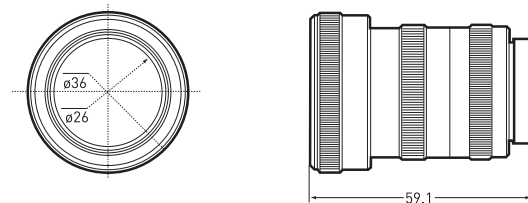

C4020F (4mm)

■ Specifications

Model	C4020F	C6020F	C8020F
Image Format	1/3" CCD	1/3" CCD	1/3" CCD
Focal Length	4.0mm	6.0mm	8.0mm
Mount (Flange Back)	C Mount (17.5mm)	C Mount (17.5mm)	C Mount (17.5mm)
F NO.	2.0	2.0	2.0
Angle of View [Diagonal]	81°	54°	38.6°
Min. Object Distance	10cm	10cm	10cm
Lens Construction	4Groups 4Elements	4Groups 4Elements	4Groups 4Elements
Iris	Fixed	Fixed	Fixed
Dimension (Dia x W)	ø30*21.6	ø30*19.2	ø30*20.2
Weight	24g	19g	25g

■ Feature

- C mount
- Fixed-focus : 4.0mm
- Fixed iris



C6020F (6mm)

■ Feature

- C mount
- Fixed-focus : 6.0mm
- Fixed iris



C8020F (8mm)

■ Feature

- C mount
- Fixed-focus : 8.0mm
- Fixed iris

■ Dimension (unit : mm)

