

UHF tags

WSTag and MTag2

New long distance passive UHF tags: WSTag for car parking solutions and MTag2 for mounting on metal. These tags operate with IR 8000 and IR 8000 w readers.

WSTag is designed for installation on the windshield inside the car. The long reading distance of this passive tag makes it ideal for parking solutions and vehicle identification.

MTag2 can be installed on metal surface by using screws and without any kind of isolation. This tag is ideal for asset tracking like identification of railway wagons, containers etc.



SPECIFICATION

Specifications	MTag2	WSTag
Carrier frequency	869Mhz	869Mhz
Size (hxxwxd)	180x14x8 mm	110x30x0,6 mm
Chip	TagiduATA5590	TagiduATA5590
Operating distance	up to 3m	Up to 2,5m
Material of housing	PVC	tag on PCB
User memory size	1kbit	1kbit
System memory size	320bit	320bit
Supported ID structures	EPC Code, ISO15961	EPC Code, ISO15961
Installation	On metal	On windscreen
Installation method	Screws	Two-side tape
Applications	Containers, trolleys, wagons	Parking areas
Colour	Black	Black, white
Temperature range	-40 to +65 °C	-40 to +65 °C
Operational (without programming)	-40 to +45 °C	-40 to +45 °C
Operational (programmed)	-50 to +85 °C	-50 to +85 °C
Storage		
Protection class	IP54	IP64

Idesco Oy reserves the right to revise this publication and to make changes to its content as well as the right to change or discontinue these products, at any time, without obligation to notify any person or entity of such revisions or changes. All trademarks and registered trademarks are property of their respective owners. Printed in Finland 3/2005

Installation instructions

WSTag and MTag2

2 pcs of (100 x 5) tapes

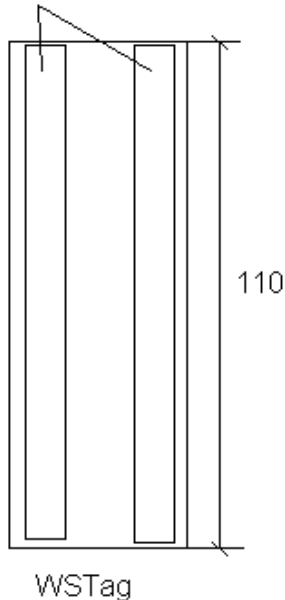

Installation of WSTag

WSTag is installed on the inside of vehicle windshield.

Use two pieces of two-side tape to install the tag.

The sticker side must be against the windshield.

WSTag should be installed in the same polarization as the reader antenna.

Note: WSTag must not block the vision of the driver.

Installation of MTag2

MTag2 is installed directly to metal surface without insulation.

The sticker side must be against the metal surface.

Use two 4mm screws. MTag2 should be installed in the same polarization as the reader antenna.

Note: Do not overtighten the screws.

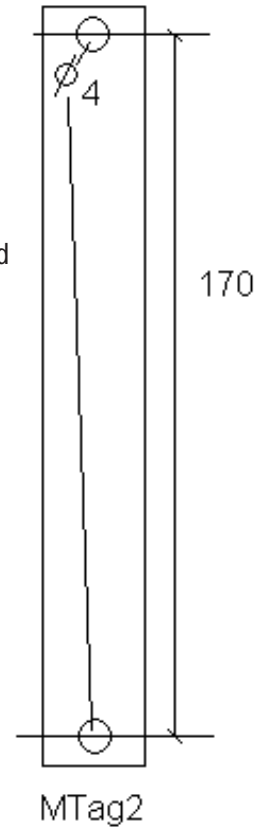

MEMORY STRUCTURE

User memory

page 7	Block 1Fh	Block 1Eh	Block 10h	Block 10h
page 6	Block 1Bh	Block 1Ah	Block 19h	Block 18h
page 5	Block 17h	Block 16h	Block 15h	Block 14h
page 4	Block 13h	Block 12h	Block 11h	Block 10h
page 3	Block 0Fh	Block 0Eh	Block 00h	Block 0Ch
page 2	Block 0Bh	Block 0Ah	Block 09h	Block 08h
page 1	Block 07h	Block 06h	Block 05h	Block 04h
page 0	Block 03h	Block 02h	Block 01h	Block 00h

bit 127
MSB
Lock bit

1-0 Bit
XXX

System memory

ID manufacturer	Block 27h	Block 26h	Block 29h	Block 28h
System info	Block 23h	Block 22h	Block 21h	Block 20h