

HTC-72 SERIES BULLET CCD CAMERA

FEATURES

- Special design DSP colour camera
- Auto trace white balance
- Electronic shutter up to 1/100,000 sec
- Adjustable bracket for wall and ceiling mount
- Corn type pinhole lens is also available

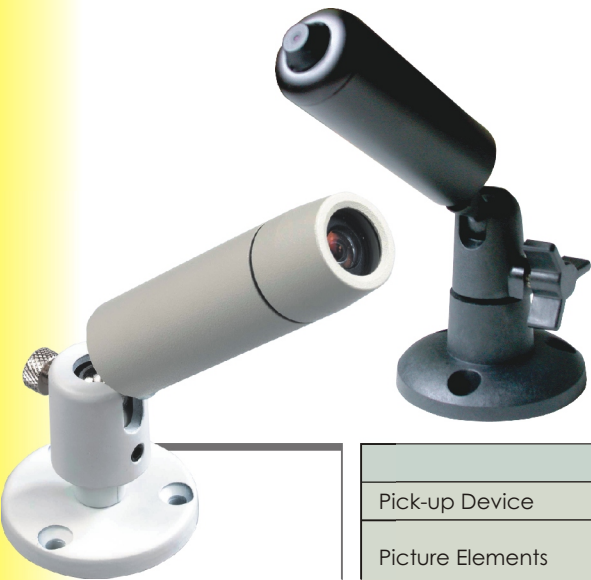

	MONOCHROME	COLOUR
Pick-up Device	1/3" CCD image sensor	1/4" CCD image sensor
Picture Elements	Samsung chip: NTSC/EIA: 510*492 PAL/CCIR: 500*582 Sharp chip: NTSC/EIA: 512*492 PAL/CCIR: 512*582	
H. Sync Frequency	NTSC/EIA:15.734 KHz, PAL/CCIR:15.625 KHz	
V. Sync. Frequency	NTSC/EIA:59.94 Hz, PAL/CCIR:50 Hz	
Synchronization	Internal	
Horizontal Resolution (TV lines)	420	380
Back Light Compensation	AUTO	
Electronic Shutter	AUTO, Range:1/50(1/60) ~ 1/100,000 sec.	
Gain Control	AUTO	
Lens	3.6mm standard, 6mm, 8mm and 12mm , 3.7mm corn type pinhole lens option	
Gamma Correction	0.45	
S/N Ratio	More than 48 dB (AGC OFF)	
Video Output	1 Vp-p, 75 Ohms	
Power Supply	12VDC (+/- 10%)	
Power Consumption	100mA (+/- 10%)	125mA (+/- 10%)
Dimensions mm	φ22 * W 76	
Weight gr	80	
Storage Temperature	-30°C ~ +60°C	
Operating Temperature	-10°C ~ +45°C	

SPECIFICATIONS ARE SUBJECT TO CHANGE WITHOUT NOTICE

Model	Image	B/W	Colour	Med-res.	Chips	Sensitivity(F2.0)	Weatherproof	Lens
HTC-721	1/3"	○		○	Samsung	0.1	○	Option
HTC-72N	1/4"		○	○	Sharp	1	○	Option
HTC-721/3.7	1/3"	○		○	Samsung	0.1		3.7mm corn type pinhole
HTC-72N/3.7	1/4"		○	○	Sharp	1		3.7mm corn type pinhole

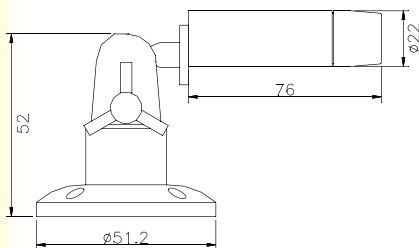

**Special Price for Over 10Pcs (Inclusive),
Please Contact:020 8965 0111 or E-mail:sales@huntelec.co.uk**

Model	DESCRIPTION
HTC-721	1/3" med-res. B/W bullet camera, 3.6mm lens, 420 TV Lines, 0.1 Lux, DC12V, weatherproof, Samsung chips
HTC-721/3.7	1/3" med-res. B/W bullet camera, 3.7mm corn type pinhole lens, 420 TV Lines, 0.1 Lux, DC12V, Samsung chips
HTC-72N	1/4" med-res. colour bullet camera, 3.6mm lens, 380 TV Lines, 1 Lux, DC12V, weatherproof, Sharp chips
HTC-72N/3.7	1/4" med-res. colour bullet camera, 3.7mm corn type pinhole lens, 1 Lux, 380 TV Lines, DC12V, Sharp chips

QUAD FAMILY

FEATURES

- Professional or economic type available
- Super high resolution picture
- 720*480 EIA/NTSC, 720*576 CCIR/PAL
- 4 camera input, 4 camera looping output



	MONOCHROME	COLOUR
System Format	Economic or professional type	
Picture Element (h*v)	NTSC:720 * 480 PAL:720 * 576	
Video Refresh Rate	60 Fields/sec	
Camera Input	1Vp-p, 75 ohms, 4 or 8 channel	
VCR Output	1Vp-p, 75 ohms *1	
Video Output for Monitor	1Vp-p, 75 ohms *1	
Alarm Output	N.C. / N.O.(normal close / open)	
Buzzer	Buzzer built in	
Switch Dwell Time	OSD programming	
Alarm Setting	OSD programming	
Alarm Trigger Input	External-alarm input (D-sub 9)	
Dimension (W*H*D)mm	323 *44*242 (HCQ - 04DD : 220*46*200)	
Weight Kg	2 (HCQ - 04DD : 1.2)	
Operating Temperature	-10°C ~ +50°C	

SPECIFICATIONS ARE SUBJECT TO CHANGE WITHOUT NOTICE



	HBQ-04BM	HCQ-04DD	HCQ-04BP	HCQ-08BP
System format	Pro. B/W	Eco. Colour	Pro. Colour	Pro. Colour
Camera input	4	4	4	8
Camera output (looping)	4		4	
VCR input	○	○	○	○
VCR output	○	○	○	○
Switch dwell time	OSD	OSD	OSD	OSD
Alarm setting	Preset	OSD	OSD	OSD
Title/Time/Date	OSD	OSD	OSD	OSD
Alarm trigger input	4	4	4	4
2*zoom play back		○	○	○
Video loss detection (alarm or freeze)	Both	Alarm	Both	Alarm
Free image in live quadrant status	○		○	
Auto gain control or trigger adjustment	AGC	AGC	AGC	AGC
Power source	12VDC	12VDC	12VDC	12VDC
Power consumption at DC power condition (watts)	4	6	11	11
Motion detection	○	○		

**Special Price for Over 10Pcs (Inclusive),
Please Contact:020 8965 0111 or E-mail:sales@huntelec.co.uk**

Model	DESCRIPTION
HBQ-04BM	4ch B/W quad with motion detection
HCQ-04DD	4ch colour quad with OSD & Motion detection
HCQ-04BP	4ch colour quad, professional type
HCQ-08BP	two page colour quad, professional type