

DS-9604/9608/9612/9616NI-SH Embedded NVR

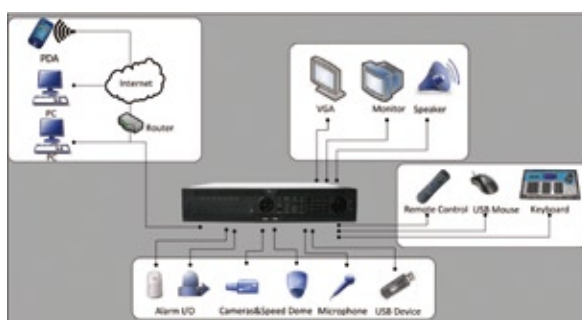

Key Features

- High performance DSP hardware decompression
- Support video & audio from network camera, network speed dome and video server
- H.264/MPEG4 compression video stream
- Up to UXGA (1600x1200) recording resolution
- Redundant HDD group management
- HDMI output at 1920x1080 resolution



Specifications

		DS-9604NI-SH	DS-9608NI-SH	DS-9612NI-SH	DS-9616NI-SH	
Video/Audio input	IP video input	4-ch 4CIF/2-ch 720P/1-ch UXGA Real Time, or 2-ch UXGA not Real Time	8-ch 4CIF/4-ch 720P/2-ch UXGA Real Time, or 4-ch UXGA not Real Time	12-ch 4CIF/6-ch 720P/3-ch UXGA Real Time, or 6-ch UXGA not Real Time	16-ch 4CIF/8-ch 720P/4-ch UXGA Real Time, or 8-ch UXGA not Real Time	
Video/Audio output	CVBS output	2-ch, BNC(1.0Vp-p, 75Ω) Resolution: 704×576(PAL); 704×480(NTSC)				
	HDMI output	1-ch, resolution: 1024×768/60Hz, 1280×1024/60Hz, 1920×1080/60Hz				
	VGA output	1-ch, resolution: 1024×768/60Hz, 1024×768/70Hz, 1280×1024/60Hz				
	Audio output	2-ch, BNC(Linear Electrical Level, 600Ω)				
	Synchronous playback	4-ch	8-ch	12-ch	16-ch	
Hard disk	Type	8 SATA interfaces				
	Capacity	More than 2TB				
External interface	Voice talk	2-ch, BNC(2.0Vp-p, 1kΩ)				
	Network interface	1RJ-45, 10/100/1000Mbps self-adaptive Ethernet interface				
	USB interface	3, USB2.0				
	Serial interface		1 RS485 serial interface			
			1 RS232 serial interface			
			1 RS-485 keyboard serial interface			
	Alarm in	16				
	Alarm out	4				
Others	Chassis	19" standard 2U chassis				
	Power supply	100~240VAC, 6.3A, 50~60Hz				
	Consumption	≤70W (without HDD)				
	Working temperature	-10°C~+55°C (14°F~131°F)				
	Working humidity	10%~90%				
	Dimension	450(W)×450(D)×95mm(H) (17.71"(W)×17.71"(D)×3.74"(H))				
	Weight(without HDD)	≤8000g (17.64lbs)				