

# DS-2CC51A7P(N)-DG1

## 700 TVL WDR Mini Camera

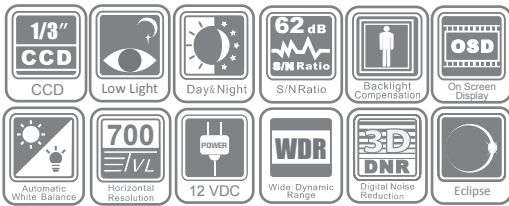

### Key features

- 1/3" SONY CCD
- 700TVL Horizontal Resolution
- Electronic Day/Night
- 3D DNR, Eclipse, EIS
- OSD Menu
- 75dB Wide Dynamic Range
- Compact Design

### Dimensions

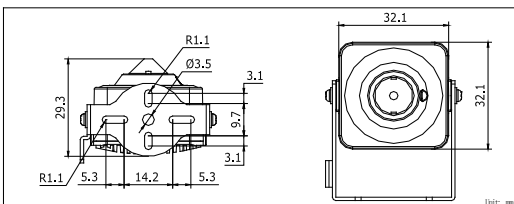

DS-2CC51A7P(N)-DG1	
<b>Camera</b>	
Image Sensor	1/3" SONY Super HAD CCD II
Signal System	PAL/NTSC
Effective Pixels	PAL: 976 (H) × 582 (V) NTSC: 976 (H) × 494 (V)
Min. Illumination	0.002 Lux @ (F1.4, AGC ON), 0.00002 Lux @ (F1.4, AGC ON, sensitivity × 512) 0.006 Lux @ (F2.5, AGC ON), 0.00006 Lux @ (F2.5, AGC ON, sensitivity × 512)
Shutter speed	PAL: 1/50 s to 1/100,000 s NTSC: 1/60 s to 1/100,000 s
Lens	3.7 mm @ F2.5 (2.8 mm optional) Angle of view: 70° (3.7 mm)
Lens Mount	M12
Day & Night	Electronic
Horizontal Resolution	700 TVL
Wide Dynamic Range	75dB
Synchronization	Internal synchronization
Video Output	1Vp-p composite output (75 Ω/BNC)
S/N Ratio	More than 62 dB
<b>Menu</b>	
Camera ID	On/Off (16 letters, position adjustable)
Auto Gain	Low/Middle/High/Off
D/N Mode	Auto/Day/Night
White Balance	Auto trace WB1/Auto trace WB2/Manual/Auto Control
Private Mask	On/Off, maximum 12 zones
Motion Detection	On/Off
BLC	Area/Value/Off
WDR	Value/ Contrast / WD exposure compensation/ Return
Anti-Flicker	On/Off
Language	English/Chinese
Function	Eclipse, Digital Noise Reduction, Sharpness, Brightness, Saturation, Resolution, Electronic image stabilization, Digital Zoom, Mirror, Defect Pixel Correction
Scene	Indoor Backlight , Outdoor Backlight
<b>General</b>	
Working Temperature/Humidity	-30 °C - 60 °C (-22 °F - 140 °F) Humidity 90% or less (non-condensing)
Power Supply	12 V DC ± 10%
Coaxial video control	support (with a compatible controller)
Power Consumption	Max. 2 W
Dimensions	32.1×32.1×29.3 mm (1.26" × 1.26" × 1.15")
Weight	300 g (0.66 lbs)

### Available models

PAL: DS-2CC51A7P-DG1  
NTSC: DS-2CC51A7N-DG1