

Motorized Zoom Lenses

Series Q

The wide range of Ernitec motorized zoom lenses will cover nearly any application.

The Series Q consist of a complete range of lenses where a 3-CAM Motor Drive is used. Triple support and guidance of the zoom and focus ensures a very smooth, silent and reliable operation. The iris is galvanometrically controlled.

Key features of the Ernitec Motorized Zoom Lenses:

- Two years warranty on Series Q.
- Feed-back potentiometer versions.
- 6 to 30 times zoom lenses, available in several configurations.



Specifications

Lens Type Q-range	Focal Length (mm)	Mount Format	Max. Apt.	Filter Thread	Horizontal Angle of View		Min. Obj. Dist. (m)	Time Z/F (sec.) @ 12 VDC	Dimensions (mm)				Weight
									A	Dmax	Lmax	H	
8 x Zoom:													
Q6Z8-1/3	6-48	CS-1/3"	1.4-360	M46x0.75	5.8°-44°	-	1.0	3.5/3	4.0	60	105	80	450g
10 x Zoom:													
Q6Z10-1/3- /2	6-60	CS-1/3"	1.6-360	M55x0.75	4.7°-44°	-	1.2	2.6/4	4.0	69	114	80	530g
Q8Z10-1/2- /2	8-80	C-1/2"	1.8-360	M55x0.75	3.1°-30°	4.6°-44°	1.2	2.6/4	4.0	69	128	80	570g
15 x Zoom:													
Q6Z15-1/3- /2	6-90	CS-1/3"	1.6-360	M55x0.75	3.1°-44°	-	1.2	3/4	4.0	69	114	80	550g
Q8Z15-1/2- /2	8-120	C-1/2"	1.8-360	M55x0.75	2.1°-30°	3.1°-44°	1.2	3/4	4.0	69	128	80	550g
18 x Zoom:													
Q11Z18-1/2- /2	11-200	C-1/2"	1.9-360	M72x0.75	1.3°-21.7°	1.9°-32.1°	1.5	6/6.5	7.5	87	171	80	735g
20 x Zoom:													
Q6Z20-1/3- /2**	5.6-112	CS-1/3"	1.6-360	M55x0.75	2.6°-47°	-	1.5	3/4	4.0	69	120	80	550g
25 x Zoom:													
Q10Z25SPNA- 1/2#)	10-250	C-1/2"	1.5-360	-	1.1°-26.3°	1.5°-35.3°	2.0	2.5/8.5	5.2	122	240.5	122	2300g
Q30Z25SPNA-1/2#)	30-750	C1/2"	4.6-720	-	0.38°-8.9°	0.5°-11.8°	2.5	8/19	5.2	122	313.2	122	2720g
30 x Zoom:													
Q5Z30-1/3	5.5-165	CS-1/3"	1.8-360	M72x0.75	1.7°-47.6°	-	1.8	6/6.5	4.0	87	167	80	870g

#) Only available in SPNA version

*) Only available in SNA version

***) Only available in SAP version

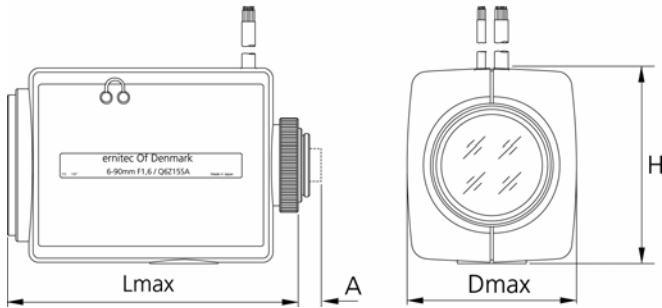

Electrical specifications:	Series Q
Auto Iris Supply voltage	8 – 16 VDC
Zoom/Focus Supply voltage	8 VDC (6-12 VDC)
Zoom/Focus Supply current, typ.	< 25 mA / function
Zoom/Focus Supply current, max.	60 mA / function
Driving coil imp. (NA types)	158 Ohm
Damp coil imp. (NA types)	1150 Ohm
Zoom/Focus feed-back (P-types)	5 KOhm
Temperature range	-10° to +50° C

Please note:

In general, the Ernitec motorised zoom lenses are available with either Direct Drive/DC Autoiris or with Video Drive Autoiris. Optionally, the lenses may be supplied with feedback potentiometers for preset operation. Please note that all combinations may not be available.

Suffix:

SA = Video Drive Autoiris

SAP = Video Drive Autoiris and Potentiometers

SNA = Direct Drive Autoiris

SPNA = Direct Drive Autoiris and Potentiometers

Easy-Click-on Auto Iris Circuit (E-Con)

The easy-click-on auto iris circuit (E-Con), shown to the right, makes a direct drive lens into an auto iris (video driven) lens in a second. Please order the E-Con separately.

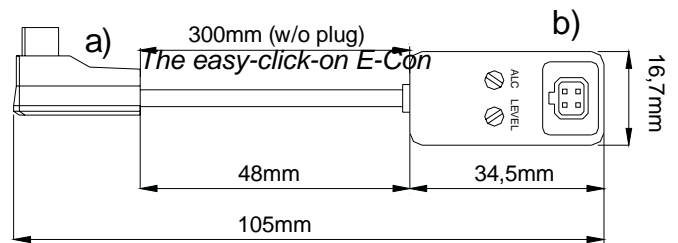

a) Plug side (to CCD Camera), b) Receptacle side (from lens)

2x Extender EX-2

The x2 extender often gives a significant cost saving. When fitted between the camera and the manual or zoom lens, the focal length effectively doubles. For example: a 75 mm F1.3 lens, plus an x2 extender, effectively becomes 150 mm F2.6.

Note: For C-mount lenses only.

Dmax = 32 mm
 Lmax = 11 mm
 A = 3.5 mm
 Weight = 38 g

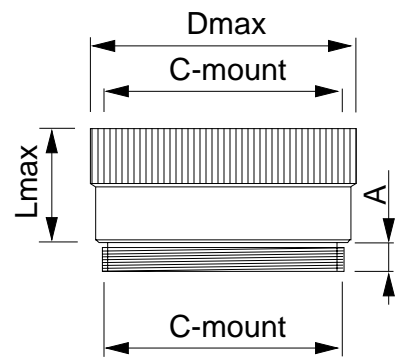

2x Extender EX-2



Denmark Head Office

Ernitec A/S
 Hørkær 24
 2730 Herlev
 Denmark
 Phone: +45 44 50 33 00
 Fax: +45 44 50 33 33
 info@ernitec.dk
 www.ernitec.com

French Branch Office

Ernitec France
 N° 29 Parc Club du
 Millenaire
 1025 Rue Henri Becquerel
 34036 Montpellier cedex 1
 France
 Phone: +33 (0) 467 151 015
 Fax: +33 (0) 467 640 181
 info@ernitec.fr
 www.ernitec.com

German Branch Office

Ernitec GmbH
 Stormarnring 28
 22145 Stapelfeld
 Germany
 Phone: +49 (0)(40)6756250
 Fax: +49 (0)(40)67562525
 info@ernitec.de
 www.ernitec.com

UK Branch Office

Ernitec UK
 Columbia House
 Columbia Drive
 Worthing
 West Sussex BN13 3HD
 UK
 Phone: +44 (0)1903263125
 Fax: +44 (0)1903263126
 info@ernitec.co.uk
 www.ernitec.com

Middle East Office

Ernitec ME
 Hamra - Makdesi Street
 Younis Center - 5th floor
 Office no. 503
 P.O.Box: 113/5721
 Beirut
 Lebanon
 Phone: +961 1 751 796
 Fax: +961 1 751 795
 info@ernitecme.com
 www.ernitecme.com