



Mounts for Monitors

FDP-No.: 20212

WM-52/315

- For Wall Mounting
- Suitable for up to 14" Monitors/TV Sets
- Load Capacity up to 12 kg
- Easy to Turn and Tilt
- Adjustable Retaining Bracket
- Easy Installation



Specifications:

Load capacity	Max. 12 kg
Mounting plate	315x270 mm
Max. turn angle	360°
Max. tilt angle	15°
Colour	Black
Dimensions (HxWxD)	See drawing
Weight	4.5 kg

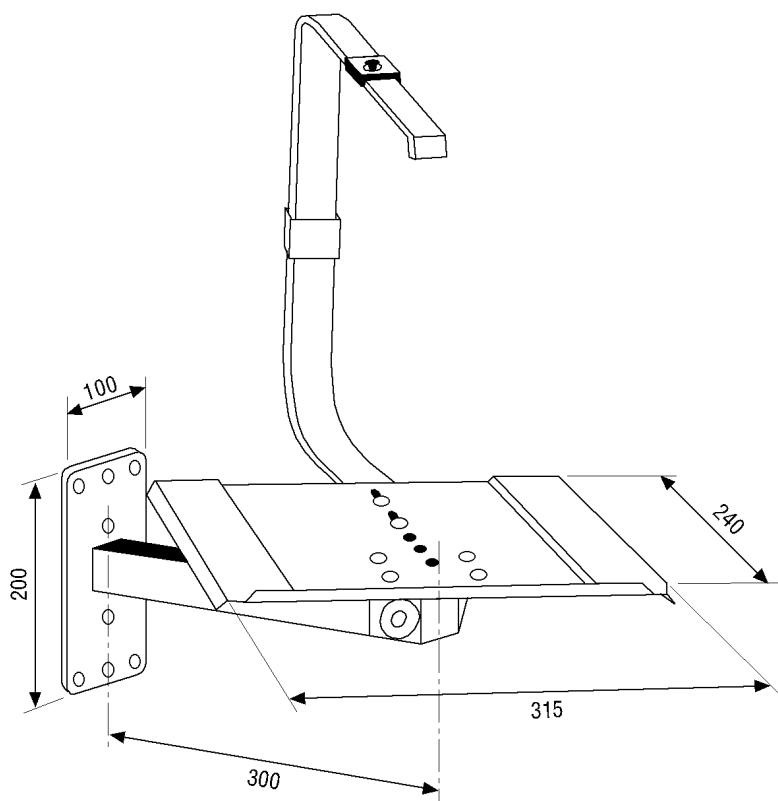

Maße/Dimensions: mm

e-mail: info@eneo-security.com • www.eneo-security.com