

Video Security

Lenses | Pinhole Lenses

A0424SNDAI

F2.4/3.8mm AI Pinhole Lens Straight 1/2"
C

Art-No. 43356



Features

Pinhole Lens
Suitable for 1/2" and 1/3" Colour and B&W Cameras
C Mount

High Standard of Optical and Mechanical Quality
Built-in Auto Iris Amplifier
Adjustable Slip-ring Mount for Cable Positioning

Specifications

Lens type	fixed focal length
Application range	security
Aspherical technology	no
Nominal format size	1/2"
Flange focal length	17.526mm
Mount	C
Focal length	3,8mm
Horizontal angle of view	80,2°
Minimum object distance (M.O.D.)	1.0m
Aperture range (F)	F2.4 ~ F360
Iris control	auto iris
Accuracy at +20°C	+/-10%
Screw-in depth	5.2mm
Filter screw size	-
Response time	approx. 4sec.
Supply voltage	8 ~ 16VDC
Input signal range	0.5 ~ 1.0Vp-p (C)VBS
Max. current consumption	40mA
Cable connection	4 pin plug with open cable end
Temperature range (Operation)	-10° ~ +50°C
Dimensions (LxD)	See drawing

(Specifications continued)

Weight

approx. 75g

Remarks

Straight design

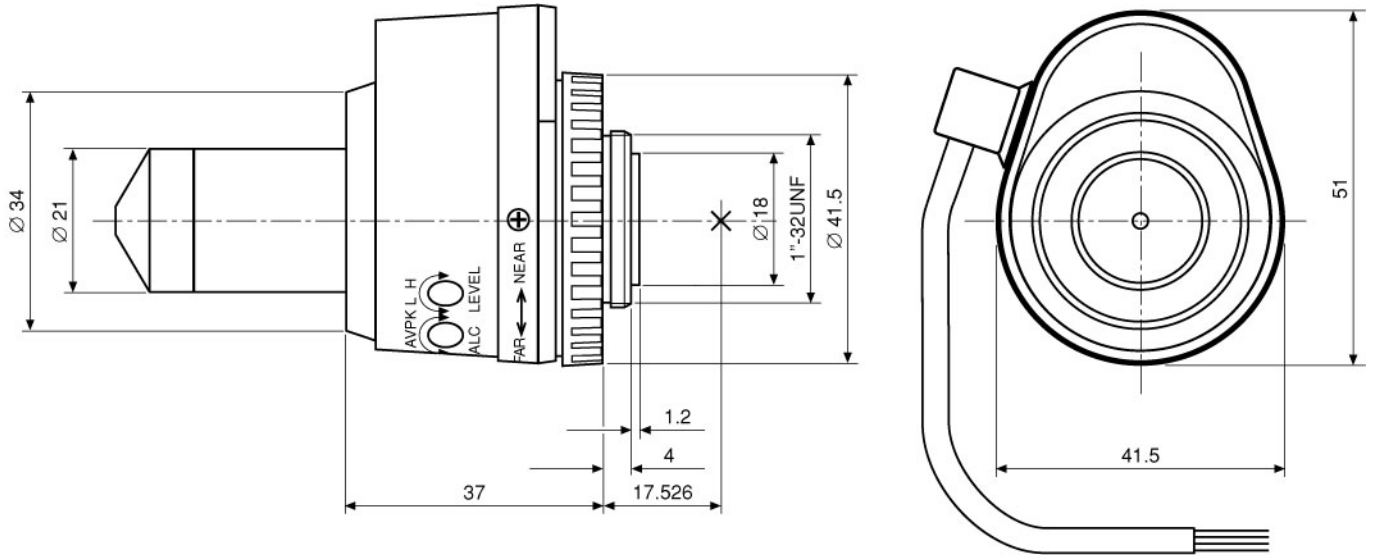

Maße/Dimensions: mm