

Our discreet 500 TVL mini domes are the ideal low-cost solution for retail applications. They can be easily mounted on the wall or the ceiling and come with an optional Quick Install Pipe that reduces installation time to a minimum.



MD3CP12H4V9I
MD3CP12H4V9IT

Features

- 3" (76mm) mini dome, ivory housing
- Resolution: 500 TVL
- Colour camera
- 1/3" Format CCD
- 4~9mm DC Iris lens
- 1.2 Lux @ F1.6
- 3-axis gimbal
- Operates on 12VDC
- Optional Quick Install Pipe
- MD3CP12H4V9I: clear bubble
- MD3CP12H4V9IT: tinted bubble

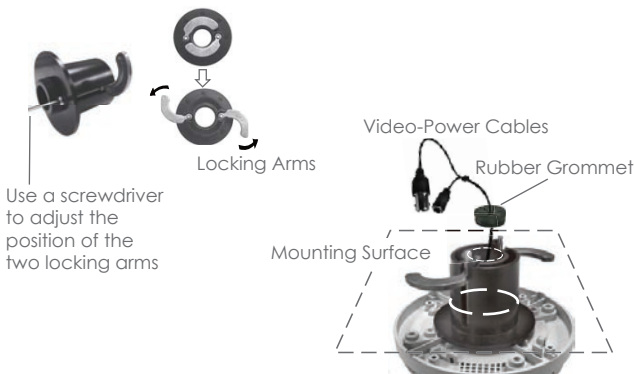
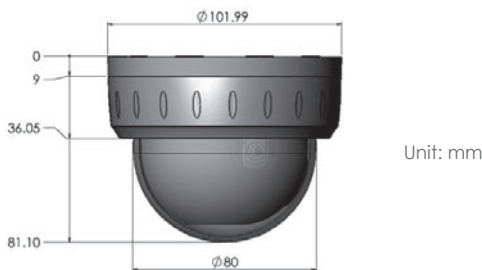
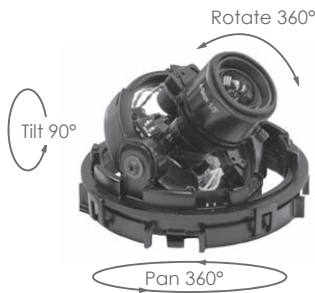

General Specifications

| | |
|-------------|--|
| Material | UV stable polycarbonate material for base Shroud and bubble Clear or tinted bubble with liner |
| Bubble | Elongated bubble to support 90 degree rotation |
| Gimbal | 3-axis gimbal |
| Integrity | Tamper proof with locking screw Dustproof |
| Fixing | Surface mount Supports direct mount to US single gang box mount Supports direct mount to UK metal electrical box |
| Lens | 4-9mm F1.6 AI/VF lens |
| Resolution | 500 TVL with basic 2 dip function |
| Image size | 1/3" Interline CCD sensor 752H x 582V pixels |
| DSP | Sony SS11X |
| Sensitivity | 1.2 Lux @ F1.6 |
| Voltage | DC 12V ±10% |

Lens Specifications

| | |
|-------------------------|---|
| Type of Focal | Varifocal, 4.0~9.0mm |
| Type of Iris | DC Drive Auto-Iris |
| Iris Range | F1.6 ~ 360 |
| Field of View | Diagonal: 92.8°~39.4° Horizontal: 71.0°~31.6° Vertical: 51.6°~23.6° |
| Minimum Object Distance | 0.15m |
| Lens Type | Aspherical |

Quick Install Kit MD-QIP (Optional)

Installer friendly.
Universal ceiling/wall mount.
Reduces installation time to a minimum.

