

DH-ITALE-080BA LED Lamp



Features

- > Adopt ATMEL AVR high capability MCU
- > Adopt Cree high capability LED, energy saving and environmental protection
- > Support RS485
- > Support adjust brightness
- > Support flash
- > Low Response time

Specifications

Model Parameter	ITALE-080BA
Main processor	ATMEL AVR MCU
User Port	RS485
LED lamp beads	20 Cree high bright LED lamp beads
Angle of illumination	25°
Day/Night function	Illume automatically according to environment brightness
Synchronization Port	1 flash signal input, 1 stroboflash signal input, 1 stroboflash signal output(I/O signal)
Synchronization Video	Support
Synchronization snapshot	Support
RS485	One RS485 Port, can connect PC
Parameter Setup	Support config by PC
Brightness of stroboflash	Support adjust
Frequency of stroboflash	Support frequency of 50、60、75、90、100、120Hz
Brightness of environment	Support adjust, 1~6
Response time	≤90us

DH-ITALE-080BA

Upgrade	By RS485
luminous flux	60lx in 20 meters
Power	AC176~264V
Power Consumption	strobflash≤50W flash≤90W
Beast using distance	18~23 meters
Working Environment	Working temperature -30℃~+70℃, Work humidity:10%~95%
Dimensions	249.6mm*210mm*109mm
Device Weight	6Kg

Dimensions (mm)

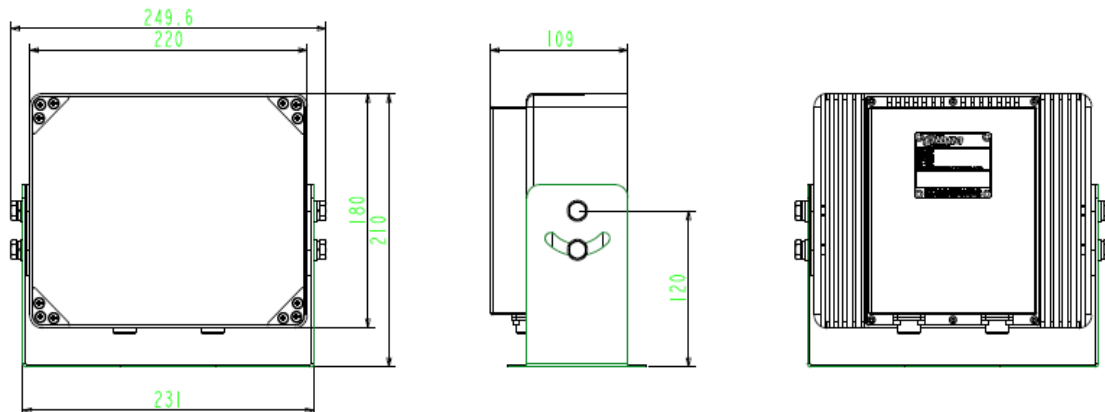

Dahua Technology Co., Ltd.

1199BinAn Road, Binjiang District, Hangzhou, China

Tel: +86-571-87688883

Fax: +86-571-87688815

Email: overseas@dahuatech.com

www.dahuatech.com

*Design and specifications are subject to change without notice.