

TST Exit Device



- * New style
- * **Built-In touch sensitive exit circuitry**
- * Surface Single Gang
- * 12-24VDC
- * Low current draw
- * Stainless steel Plate
- * Remote Plate Option
- * Changeover relay
- * Adjustable relay time
- * LED & Audible Signals

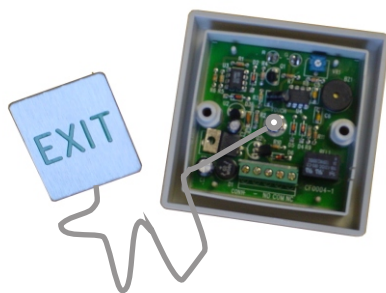

Plate can be fixed
remotely from
electronics

Specification

Product Code:	TST
Voltage:	12/24vdc
Current:	15mA Rest
Temp range:	-20 to +50 degrees C
Indication:	Electronic beep + LED's
Output Relay:	Changeover
Relay timer:	Adjustable 1-15 secs
Dimensions:	89 x 89 x 38mm (h x w x d)

*Making your security
a permanent asset...*