

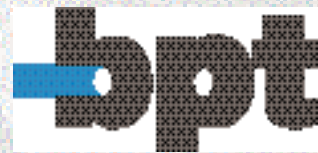

Audio entry system

2000

System

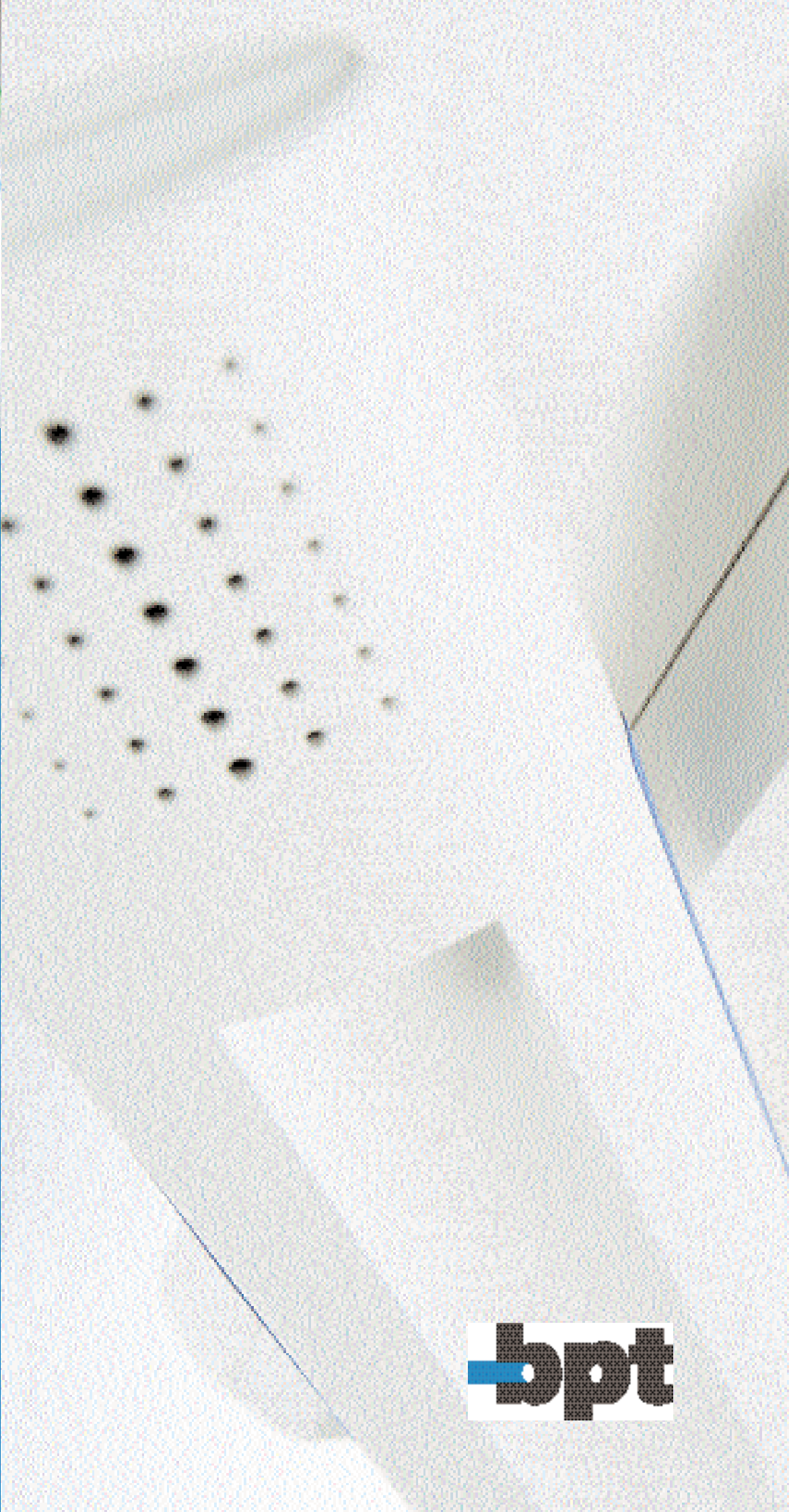

The system 200 features

bpt's System 200 is a comprehensive system which makes possible analogue-call installations and, with the addition of a few simple accessories (coder in the handset or installed locally), digital-call installations too. The system prides itself on its flexibility: both entry panels and handsets are modular to meet the individual needs of the installation, enabling the system to grow, adding new functions without altering the existing setup. In addition, the system can be connected to the house's telephone system, enabling calls from the telephone to the audio entry system. A special function also lets calls from the entry panel be rerouted onto the local line, enabling the inhabitant to answer even when he is out, whether from a standard set or a mobile phone.

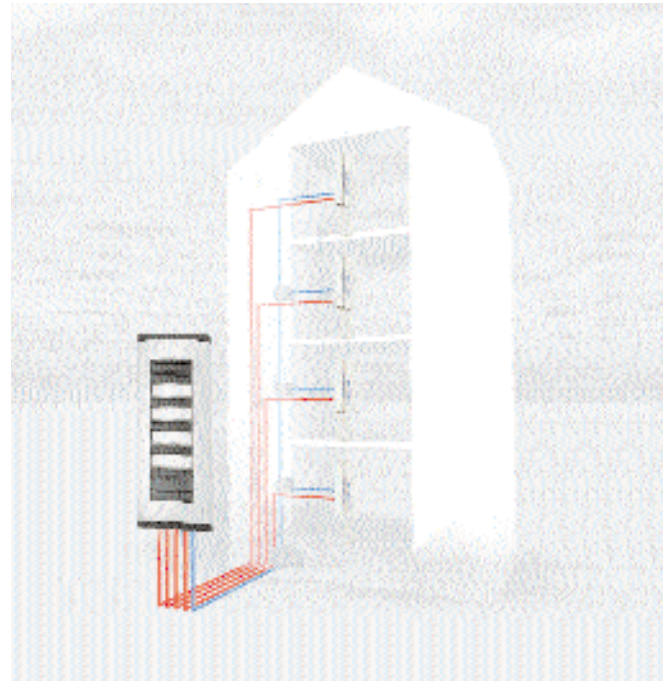

Digital or analogue: it's up to you

With just a few accessories, the analogue system can be transformed into a digital one, without having to change the handsets.

Exedra XC/200

È un nuovo citofono del sistema 200, disponibile in versione da parete e da tavolo. Grazie alla sua modularità, espandere le sue funzioni è un gioco da ragazzi.

The new system 200 handset, available in wall mounted and table-top versions. Thanks to its modularity, expanding its functions is child's play.

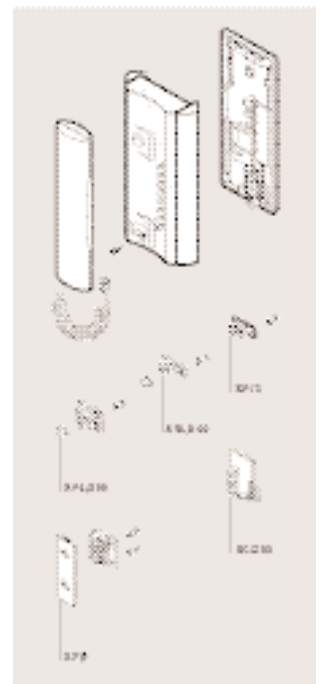

Easy and personalized assembly

The handset can be customized to suit your needs.



Inimitable style which even looks good on the table

The innovative design of the mounting transforms Exedra into an elegant table-top handset.

The Exedra handset in the wall mounted version

Nova 200

Thanks to its compact size, it is easily installed inside the regular 3-module boxes, accommodating all the main commercially available front plates from the civil series.

The Nova twin-channel receiver



Twin-channel receiver

The twin-channel receiver features a circuit suppressing the Larsen effect.

The dimensions of the three-module box

96x59x49.8 mm



The C/200 handset

The **bpt** C/200 handset, with its no-nonsense linear design, blends into any room of the house. Being modular, it is easily customized to suit on individual needs.



C/200
Compact and elegant with simple functionality.



Perfect audio
With a frequency range from 300 to 5,000 Hz, the audio quality is assured.

Available in wall mounted or table-top versions

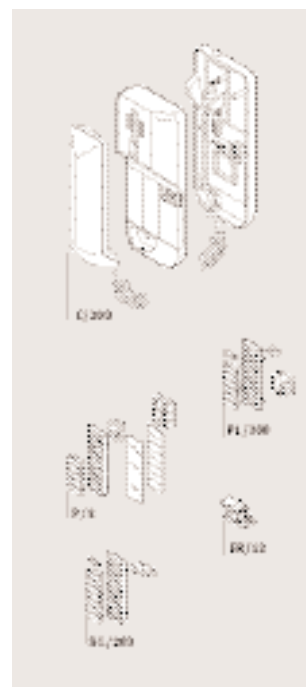

Targha 200

An exterior modular entry panel which does not require a rainshield. Combining just a few elements, it meets any installation need. With its compact form, it can be either recessed or surface mounted, installed either horizontally or vertically.

Three colour options: white, gold and silver.

The back-lit buttons with magnifying-effect transparent cover make it easier to read the names.

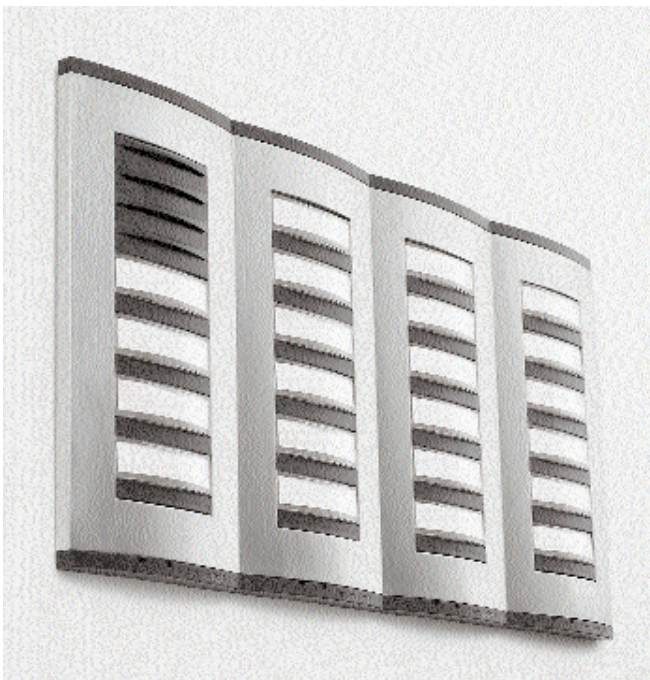

Recessed version

Barely 99 mm wide and 207 mm tall, the entry panel can also be recessed in standard 100 mm columns.



Surface mounted version

Measuring just 28 mm in depth for a minimal architectural impact.

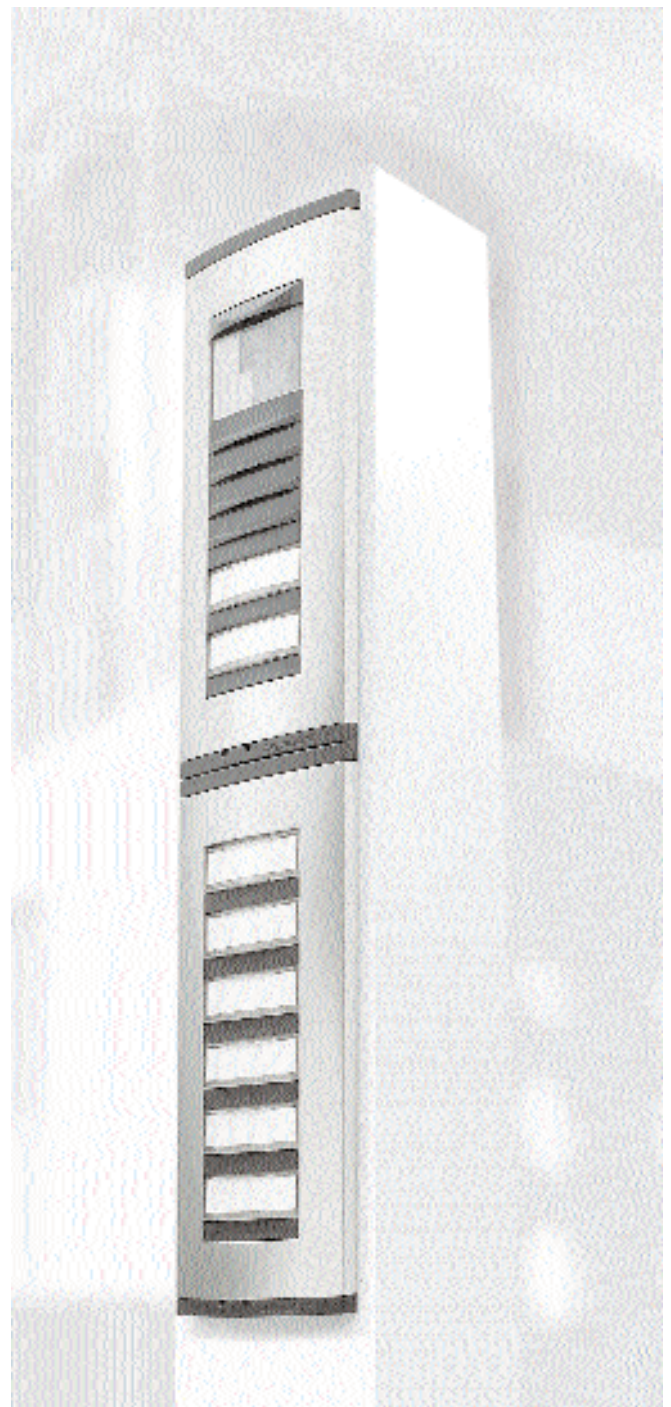

TM/200 modular entry panel

It can be installed either horizontally or vertically. Available in two-, three- or four-module versions, it provides an alternative solution to installation requirements.

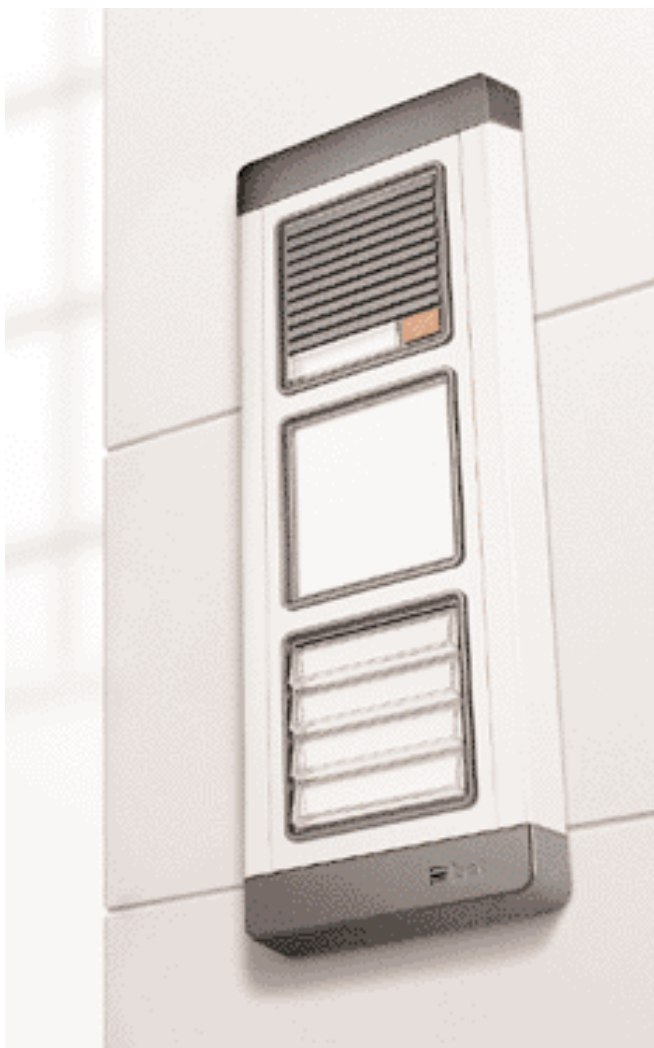

The modular TM series entry panel

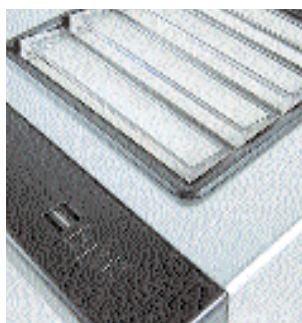
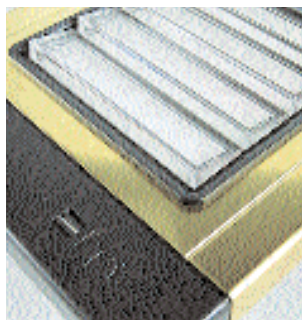

White, gold, silver

Three colour options to fit in with the individual character of the property.



A single power supplier whatever the requirement

All bpt's technology in this neat little package.



BPT SpA
Via Roma, 41
30020 Cinto Caomaggiore
(Venezia) Italy
Tel. +39 0421.241.241 r.a.
Fax +39 0421.241.053
www.bpt.it - bpt@adria.it



ISO 9001:2008
UNI EN ISO 9001 CERTIFICATO N° 14138/01

