

**BOSCH**

Invented for life

# EXMB.020 L-bracket



- ▶ **Simple, effective L-bracket**
- ▶ **Made of thick flat-bar aluminum**
- ▶ **Versatile design reduces installation time**

This heavy duty wall bracket is designed to fit small enclosures for tight locations. The pan-adjusted bolt on the underside can also be used to hang infrared illuminators such as the UF100 and UF500 models.

## Installation/Configuration Notes

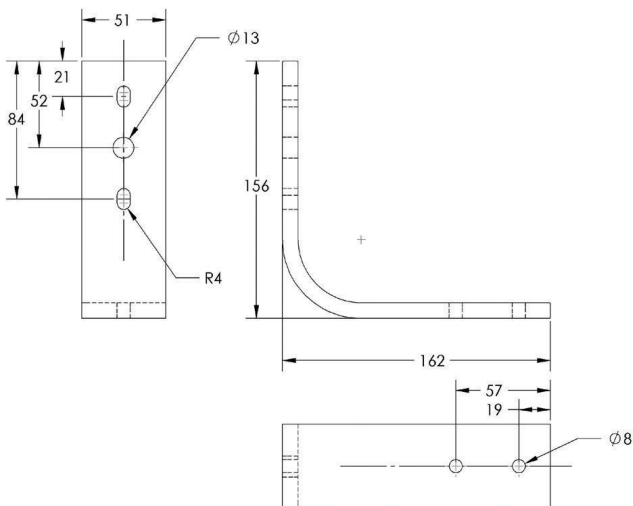

## Parts Included

- Wall mount anchors not included.

## Technical Specifications

Material	3/8 in thick aluminum
Coating	Black (Standard) White (Optional)
Weight	0.55 kg (1.2 lbs)
Maximum Load	11.4 kg (25 lbs)

## Ordering Information

<b>EXMB.020B L-bracket</b> L-Bracket Only, Heavy Duty, black	<b>EXMB.020B</b>
<b>EXMB.020W L-Bracket</b> L-Bracket Only, Heavy Duty, white	<b>EXMB.020W</b>

**Americas:**  
Bosch Security Systems, Inc.  
130 Perinton Parkway  
Fairport, New York, 14450, USA  
Phone: +1 800 289 0096  
Fax: +1 585 223 9180  
security.sales@us.bosch.com  
www.boschsecurity.us

**Europe, Middle East, Africa:**  
Bosch Security Systems B.V.  
P.O. Box 80002  
5600 JB Eindhoven, The Netherlands  
Phone: + 31 40 2577 284  
Fax: +31 40 2577 330  
emea.securitysystems@bosch.com  
www.boschsecurity.com

**Asia-Pacific:**  
Robert Bosch (SEA) Pte Ltd, Security Systems  
11 Bishan Street 21  
Singapore 573943  
Phone: +65 6258 5511  
Fax: +65 6571 2698  
apr.securitysystems@bosch.com  
www.boschsecurity.com

**Represented by**