

BP0004/5-PTC

4 Channel 5Amp Power Supply with PTC Fuse



Positive Temperature Coefficient device
(PTC, commonly known as a resettable fuse)

■ Features:

- Simple Solution for CCTV Power Supply
- 4 Channel 5Amp Distribution System
- Built-in 6A PTC Fuse for Maximum Protection
- Adjustable Output Voltage for Long Distance Transition, DC12V to 13.8V
- Universal Voltage Input, AC90V to AC264V
- LED Indication Light

■ Installation Diagram:

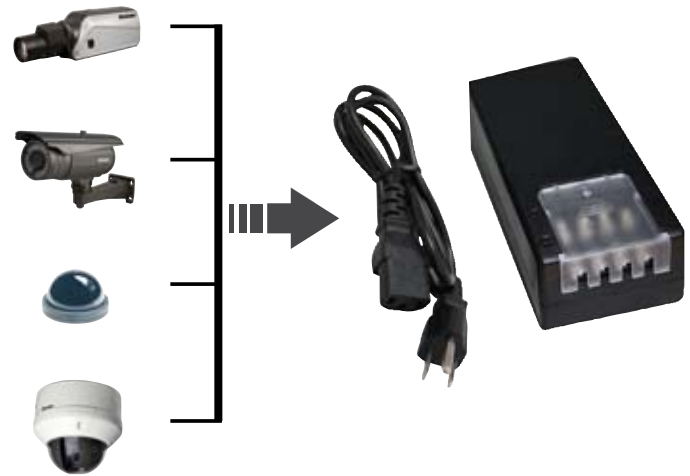

Support up to 4 devices with adjustable voltage

■ Specification:

Model Number	BP0004/5-PTC
Output Effective Power	60W
Input Voltage	AC90V - AC264V
Output Current	5A
Output Adjustable Voltage	DC12V ~ DC13.8V
Output Channel	4 Channels
Built-in PTC Fuse	6A
Working Temperature	-22°F ~ 115°F
Working Environment	20% ~ 90% RH

For more information or technical support, please call (909) 305-8889 or log on to www.bolideco.com

468 South San Dimas Avenue, San Dimas CA 91773 | Tel: (909) 305-8889 Fax: (909) 305-0999

Bolide Technology Group makes no representation concerning the legality of certain product application. We encourage you to check and comply with all applicable local state, and federal laws. Specification and availability are subject to change without notice. All trademarks, registered trademarks, and names are the property of their respective owners.