

SurroundVideo®

180° and 360° Coverage in an All-in-One Vandal Resistant Dome

SurroundVideo® Cameras

| 8MP Panoramic 180° | 8MP Panoramic 360° | 20MP Panoramic 180° | 20MP Panoramic 360° | 40MP Panoramic 180° |
|--------------------|--------------------|---------------------|---------------------|---------------------|
| AV8185CO | AV8365CO | AV20185CO | AV20365CO | AV40185DN |
| AV8185CO-HB | AV8365CO-HB | AV20185CO-HB | AV20365CO-HB | AV40185DN-HB |
| AV8185DN | AV8365DN | AV20185DN | AV20365DN | |
| AV8185DN-HB | AV8365DN-HB | AV20185DN-HB | AV20365DN-HB | |



180° Panoramic



360° Panoramic

SurroundVideo® panoramic view megapixel IP cameras provide all-in-one solutions for wide area video surveillance. Four sensors and lenses are housed in a vandal-resistant IP66 dome enclosure. The cameras are available in 180° and 360° configurations and resolutions of 8-, 20- and 40-megapixels (MP). A single SurroundVideo® panoramic camera can replace multiple conventional cameras with the ability to zoom into multiple regions of interest. Their return on investment is easily measured any way you view it.



180° Panoramic at 8, 20 and 40MP



360° Panoramic at 8 and 20MP



Dual Encoder H.264/MJPEG



True Day/Night



Pixel Binning for Superior Low Light Performance (20 and 40MP)



All-in-One Dome Solution with Integrated Lens



Vandal and Weather Proof IK-10 and IP66 Rated

Features:

- Industry's First 8MP, 20MP and 40MP Panoramic Megapixel Cameras
- Dual Encoder H.264/MJPEG
- Indoor/Outdoor IP66, Vandal Resistant and IK-10 Rated Dome
- Binning Mode to Increase Sensitivity (20MP and 40MP)
- Reduced Overall System Cost
- Easily Adjustable 2-Axis Camera Gimbal with 360° Pan and 90° Tilt
- +/- 5° Electrical Vertical Alignment to Locate Each Sensor Position (180° Series)
- +/- 10° Mechanical Tilt Adjustment to Locate Each Sensor Angle (360° Series)
- Bit Rate Control, Privacy Mask and Multi-Streaming
- Forensic Zooming
- PoE and Auxiliary Power: 12–48V DC/24V AC
- Complete Mounting Options

Model Specific Features

| Model | Resolution | Field of View | Frame Rate | Feature |
|---------|------------|---------------|------------|---------|
| AV8185 | 8MP | 180° | 6fps | |
| AV8365 | 8MP | 360° | 6fps | |
| AV20185 | 20MP | 180° | 3.5fps | Binning |
| AV20365 | 20MP | 360° | 3.5fps | Binning |
| AV40185 | 40MP | 180° | 1.5fps | Binning |

Build-to-Order Options

| | |
|-----|-----------------|
| CO | Color |
| DN | Day/Night |
| -HB | Heater & Blower |

Camera Imaging Specifications

| Model | AV8185 | AV8365 | AV20185 | AV20365 | AV40185 | |
|----------------------|----------------------------------|----------------------------------|------------------------------|--|--|---------------------|
| Image Sensor (CMOS) | 8MP = 2MP x 4 | 8MP = 2MP x 4 | 20MP = 5MP x 4 | 20MP = 5MP x 4 | 40MP = 10MP x 4 | |
| H-FOV | 180° | 360° | 180° | 360° | 180° | |
| Optical Format | 1/2" | 1/2" | 1/2.5" | 1/2.5" | 1/2.3" | |
| Pixel Pitch | 4.2µm | 4.2µm | 2.2µm | 2.2µm | 1.67µm | |
| Minimum Illumination | Color | 0.1 Lux | 0.1 Lux | 0.3 Lux | 0.3 Lux | 0.42 Lux |
| | Color Binning | - | - | 0.15 Lux | 0.15 Lux | 0.21 Lux |
| | Day/Night (-DN Version) | 0 Lux, IR sensitive | 0 Lux, IR sensitive | 0 Lux, IR sensitive | 0 Lux, IR sensitive | 0 Lux, IR sensitive |
| Full FOV Resolution | Total | 6400 H x 1200 V | 6400 H x 1200 V | 10240 H x 1920 V | 10240 H x 1920 V | 14592 H x 2752 V |
| | Per Sensor | 1600 H x 1200 V | 1600 H x 1200 V | 2560 H x 1920 V | 2560 H x 1920 V | 3648 H x 2752 V |
| 1/4 Resolution | Total | 3200 H x 600 V | 3200 H x 600 V | 5120 H x 960 V | 5120 H x 960 V | 7296 H x 1376 V |
| | Per Sensor | 800 H x 600 V | 800 H x 600 V | 1280 H x 960 V | 1280 H x 960 V | 1824 H x 1376 V |
| Dynamic Range | 61dB | 61dB | 70.1dB | 70.1dB | 57.2dB | |
| Frame Rates | Full Resolution | 6fps (6400x1200) | 6fps (6400x1200) | 3.5fps (10240x1920) 4.2fps (10240x1600) | 3.5fps (10240x1920) 4.2fps (10240x1600) | 1.5fps (14592x2752) |
| | 1/4 Resolution | - | - | 11fps (5120x960) | 11fps (5120x960) | 5.5fps (7296x1376) |
| | Binning Mode | - | - | 13fps (5120x960) | 13fps (5120x960) | 6.5fps (7296x1376) |
| Lens | CS, F1.8, 7.8mm, IR, H-FOV = 47° | CS, F1.8, 3.5mm, IR, H-FOV = 96° | CS, F1.8, 6.2mm, H-FOV = 47° | CS, F1.8, 3.5mm, H-FOV = 96° | CS, F2.4, 7.2mm, H-FOV = 47° | |

| | | |
|-------------------|-------------------|---|
| Data Transmission | Compression Type | H.264 (MPEG-4, Part 10)/Motion JPEG 21 levels of quality |
| | Network Protocols | RTSP, RTP/TCP, RTP/UDP, HTTP, DHCP, TFTP |
| | Network Interface | 100Base-T Ethernet |
| | Multi-Streaming | Non-identical streams (2 per sensor) |

| | | |
|---------------|--------------------------|---|
| Environmental | Operating temperature | -40°C (-40°F) to +50°C (122°F) w/Heater |
| | Humidity | 0% to 90% (non-condensing) |
| | Stable image temperature | 0°C (32°F) to +50°C (122°F) |
| | Storage temperature | -30°C (-22°F) to +60°C (140°F) |

| | |
|-----------------|--|
| Programmability | On-camera real-time motion detection and privacy mask with up to 1024 detection zones (per sensor) |
| | Privacy mask |
| | Pixel Binning Mode (20 and 40MP) |
| | +/-5° Digital Vertical Alignment to adjust images |
| | Flexible Cropping (resolution windowing down to 1x1 pixel for JPEG and 2x2 pixels for H.264) |
| | Low light noise filter control |
| | Bit rate and bandwidth limitation control |
| | Backlight compensation and auto multi-matrix white balance |
| | 50/60Hz selectable flicker control |
| | Electronic pan, tilt, zoom (PTZ) and image flip 180° |
| | Programmable resolution, brightness, saturation, gamma, sharpness, tint |
| | Bandwidth and storage savings by running at 1/4 resolution |
| | Simultaneous delivery of full field-of-view and zoomed images |
| | Programmable shutter speed to help control motion blur |

| | | | |
|------------|-----------------------|---|--|
| Mechanical | Casing | Die-cast aluminum chassis with 5.5" (140mm) polycarbonate dome bubble IP66 weather proof standard Vandal resistant, IK-10 rated | |
| | Gimbal | Easily adjustable, 2-axis w/360° pan and 90° tilt | |
| | Total Unit Dimensions | Unit | Ø6.9" (175mm) x 6.55" H (166mm) |
| | | Bubble Only | Ø5.5" (140mm) x 3.4" H (87mm) |
| | | Packaged | 8.5" (215mm) x 8.5" (215mm) x 8.5" (215mm) |
| | Weight | Unit | 3.81 lbs (1.75kg) |
| Packaged | | 4.63 lbs (2.1kg) | |

| | | |
|------------|-------------------|--|
| Compliance | Industry Standard | ONVIF Conformant |
| | Listings | UL (CB) |
| | FCC Compliance | 47 CFR 15 Class A |
| | Environmental | RoHS, REACH, WEEE |
| | Markings | (CE) EN55022 Class A, EN55024, EN61000-3-2, EN61000-3-3, EN60950-1 |
| | Mechanical | IK-10 (EN62262), IP66 (EN60529) |

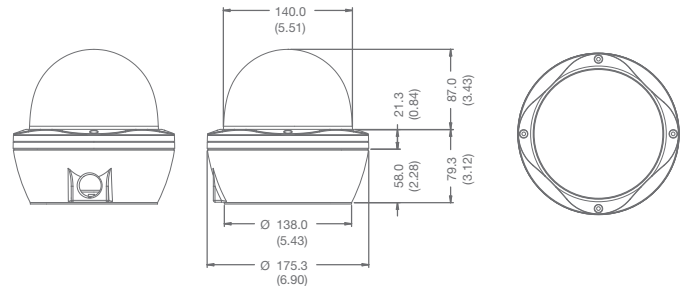

| | | |
|------------|---------------------|--|
| Electrical | Input/Output | General purpose opto-coupled |
| | Power Over Ethernet | PoE 802.3af, Class 3 |
| | Auxiliary Power | 12-48V DC, 24V AC |
| | Power Consumption | AV8185/AV8365: 9 Watts DC Power AV20185/AV20365: 9 Watts DC Power AV40185: 11.7 Watts DC Power |

| | | |
|-------------|---------------------------|---|
| Accessories | MD-PMA | Pole Mount Adapter |
| | MD-CRMA | Corner Mount Adapter |
| | SV-CMT | Ceiling Mount (Fit 1.5" NPT) |
| | SV-EBA | Electrical Box Adapter |
| | SV-FMA | Flush Mount Adapter |
| | SV-JBA | Junction Box Adapter (Fit 3/4" NPT Conduit) |
| SV-WMT | Wall Mount (Fit 1.5" NPT) | |

| | | |
|--|---------------|--|
| Heater & Blower Electrical (-HB only) | Voltage Input | 12V to 20V DC/24V AC (separate power required) |
| | Power Output | 11W Max (DC 12V); 13W Max (AC 24V) |
| | Heater Switch | On: 17°C (62.6°F), Off: 30°C (86°F) |
| | Blower Switch | On: 10°C (50°F), Off: 15°C (59°F) On: 50°C (122°F), Off: 45°C (113°F) |